

Shelby County Clerk/Recorder
301 E. Main St. PO Box 230
Shelbyville, IL 62565

Map Produced by:
Bruce Harris & Associates, Inc.
21 N. River St.
Batavia, IL 60510
www.bruceharris.com

August 2022

ASH GROVE PRECINCT

Shelby County Clerk

| | |
|----------------------|---------------------|
| Precincts | Hydrography |
| Sections | Political Townships |
| Corporate Boundaries | |

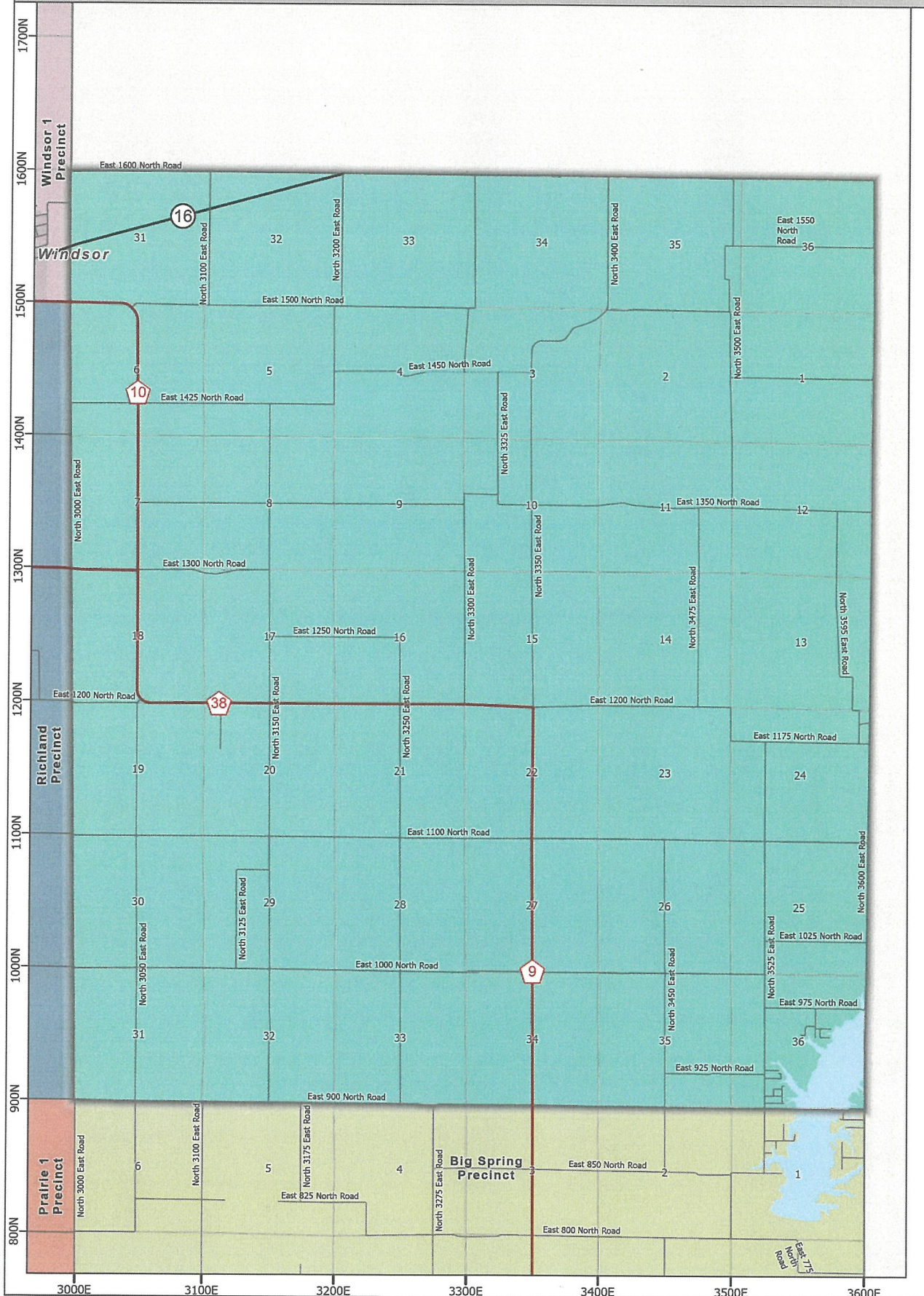
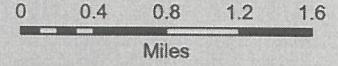

Shelby County Clerk/Recorder
301 E. Main St. PO Box 230
Shelbyville, IL 62565

Map Produced by:
Bruce Harris & Associates, Inc.
21 N. River St.
Batavia, IL 60510
www.bruceharris.com

August 2022

BIG SPRING PRECINCT

Shelby County Clerk

| | |
|----------------------|---------------------|
| Precincts | Hydrography |
| Sections | Political Townships |
| Corporate Boundaries | |

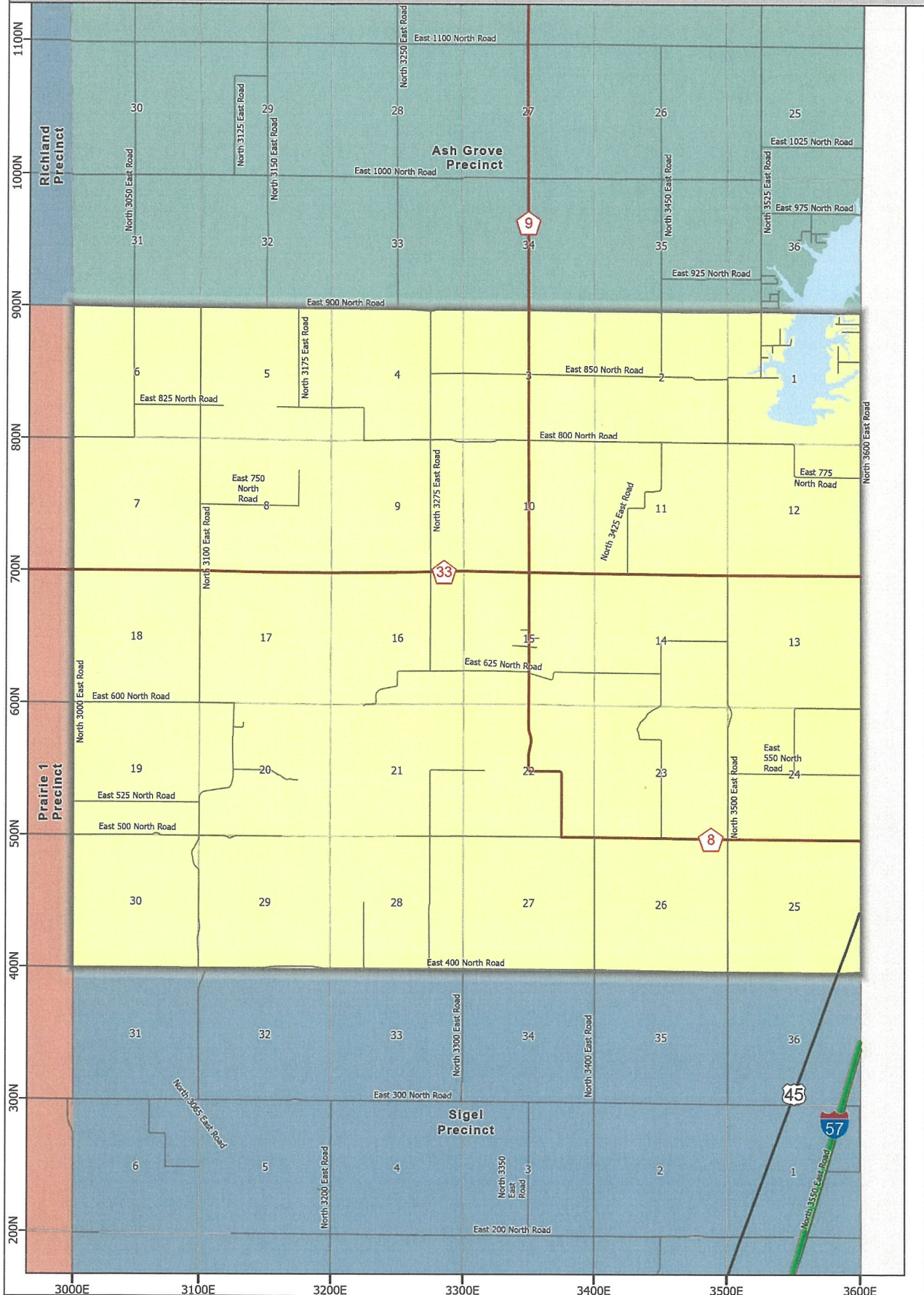
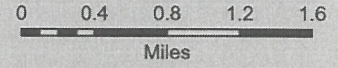

Shelby County Clerk/Recorder
301 E. Main St. PO Box 230
Shelbyville, IL 62565

Map Produced by:
Bruce Harris & Associates, Inc.
21 N. River St.
Batavia, IL 60510
www.bruceharris.com

August 2022

CLARKSBURG PRECINCT

Shelby County Clerk

| | |
|----------------------|---------------------|
| Precincts | Hydrography |
| Sections | Political Townships |
| Corporate Boundaries | |

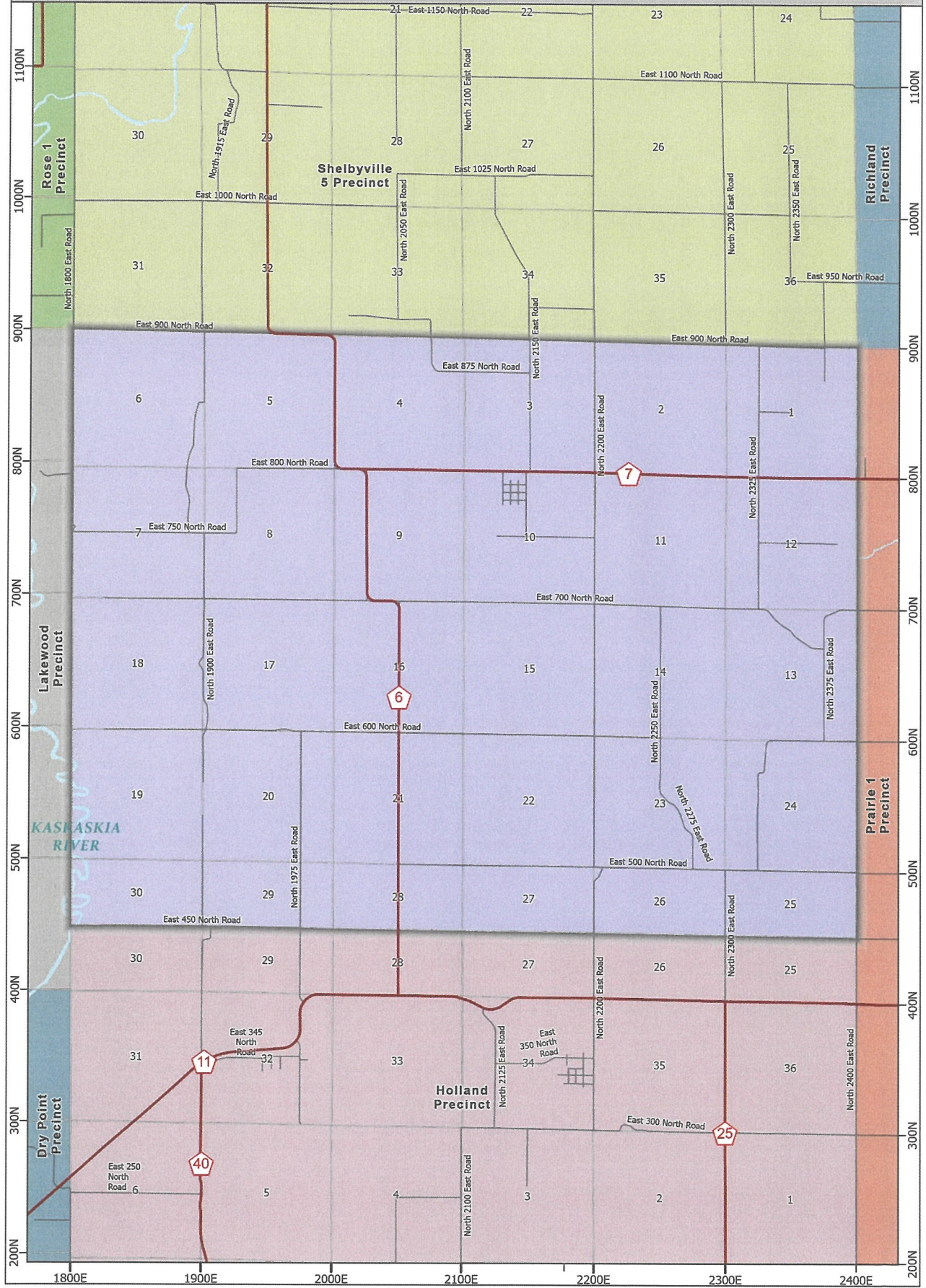
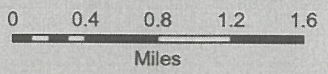

Shelby County Clerk/Recorder
301 E. Main St. PO Box 230
Shelbyville, IL 62565

Map Produced by:
Bruce Harris & Associates, Inc.
21 N. River St.
Batavia, IL 60510
www.bruceharris.com

August 2022

COLD SPRING PRECINCT

Shelby County Clerk

| | |
|----------------------|---------------------|
| Precincts | Hydrography |
| Sections | Political Townships |
| Corporate Boundaries | |

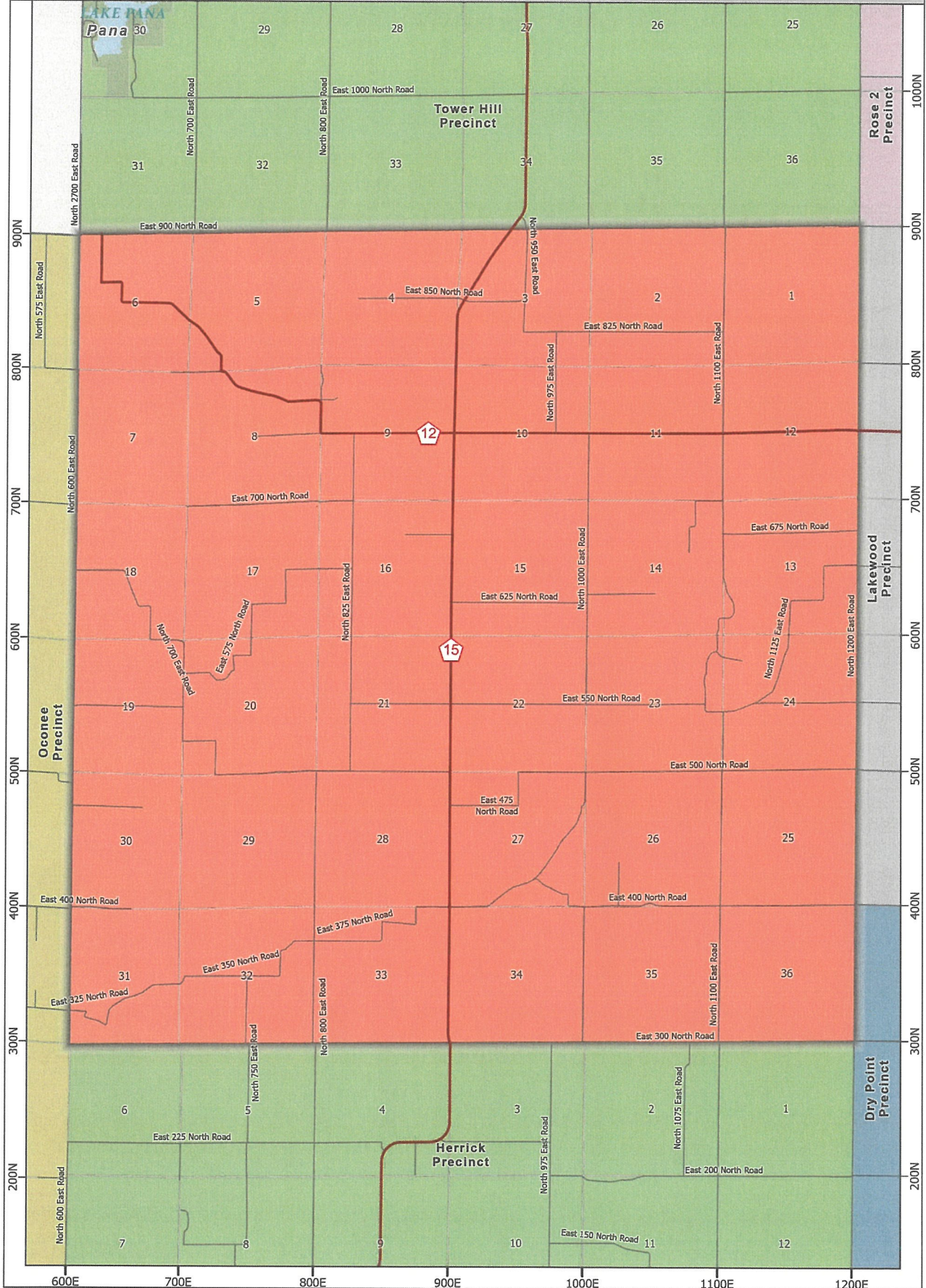
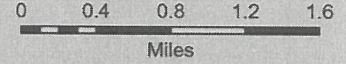

Shelby County Clerk/Recorder
301 E. Main St. PO Box 230
Shelbyville, IL 62565

Map Produced by:
Bruce Harris & Associates, Inc.
21 N. River St.
Batavia, IL 60510
www.bruceharris.com

August 2022

DRY POINT PRECINCT

Shelby County Clerk

| | |
|----------------------|---------------------|
| Precincts | Hydrography |
| Sections | Political Townships |
| Corporate Boundaries | |

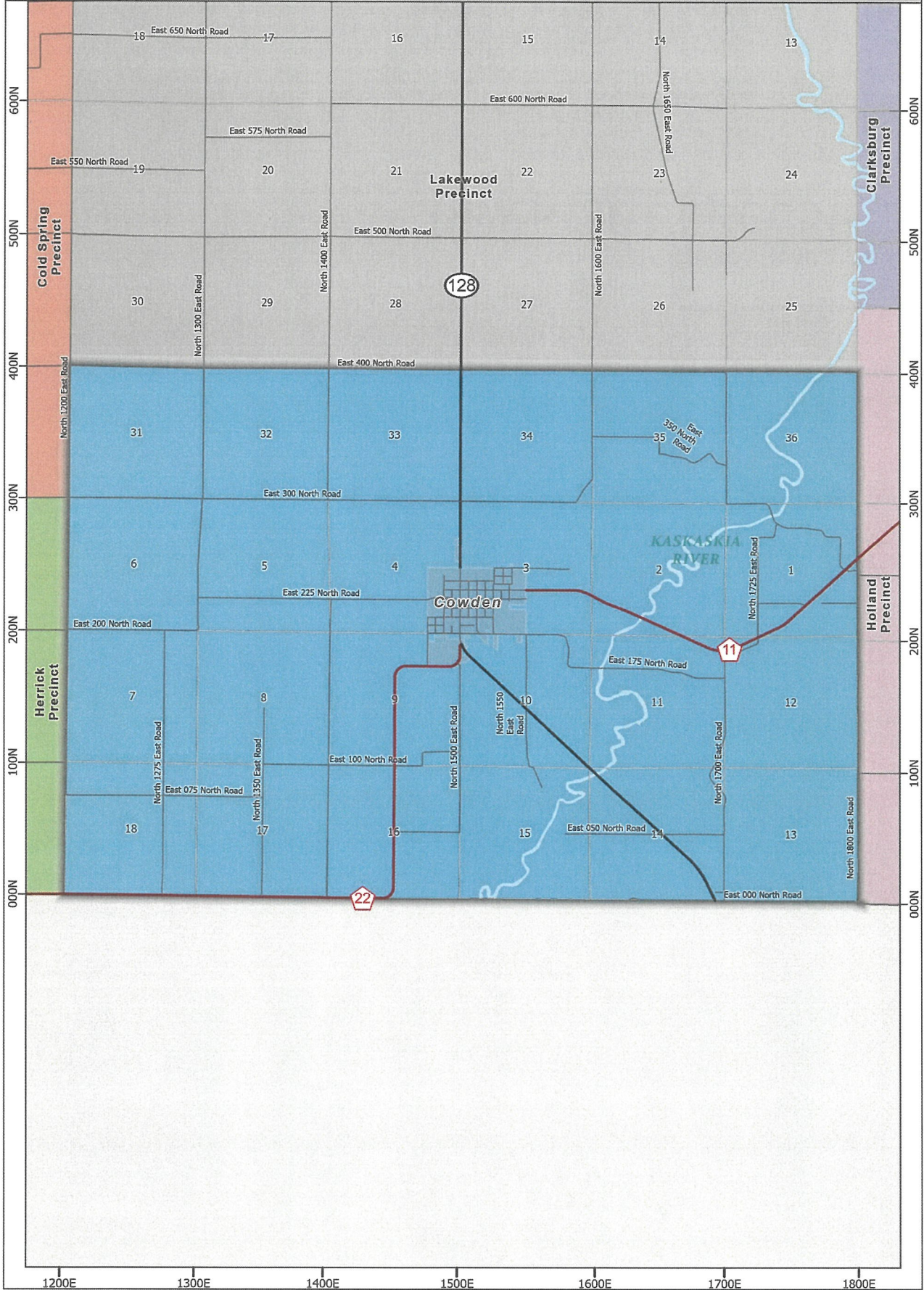
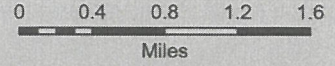

Shelby County Clerk/Recorder
301 E. Main St. PO Box 230
Shelbyville, IL 62565

Map Produced by:
Bruce Harris & Associates, Inc.
21 N. River St.
Batavia, IL 60510
www.bruceharris.com

August 2022

FLAT BRANCH PRECINCT

Shelby County Clerk

| | |
|----------------------|---------------------|
| Precincts | Hydrography |
| Sections | Political Townships |
| Corporate Boundaries | |

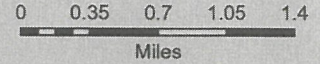

Shelby County Clerk/Recorder
301 E. Main St. PO Box 230
Shelbyville, IL 62565

Map Produced by:
Bruce Harris & Associates, Inc.
21 N. River St.
Batavia, IL 60510
www.bruceharris.com

August 2022

HERRICK PRECINCT

Shelby County Clerk

| | |
|----------------------|---------------------|
| Precincts | Hydrography |
| Sections | Political Townships |
| Corporate Boundaries | |

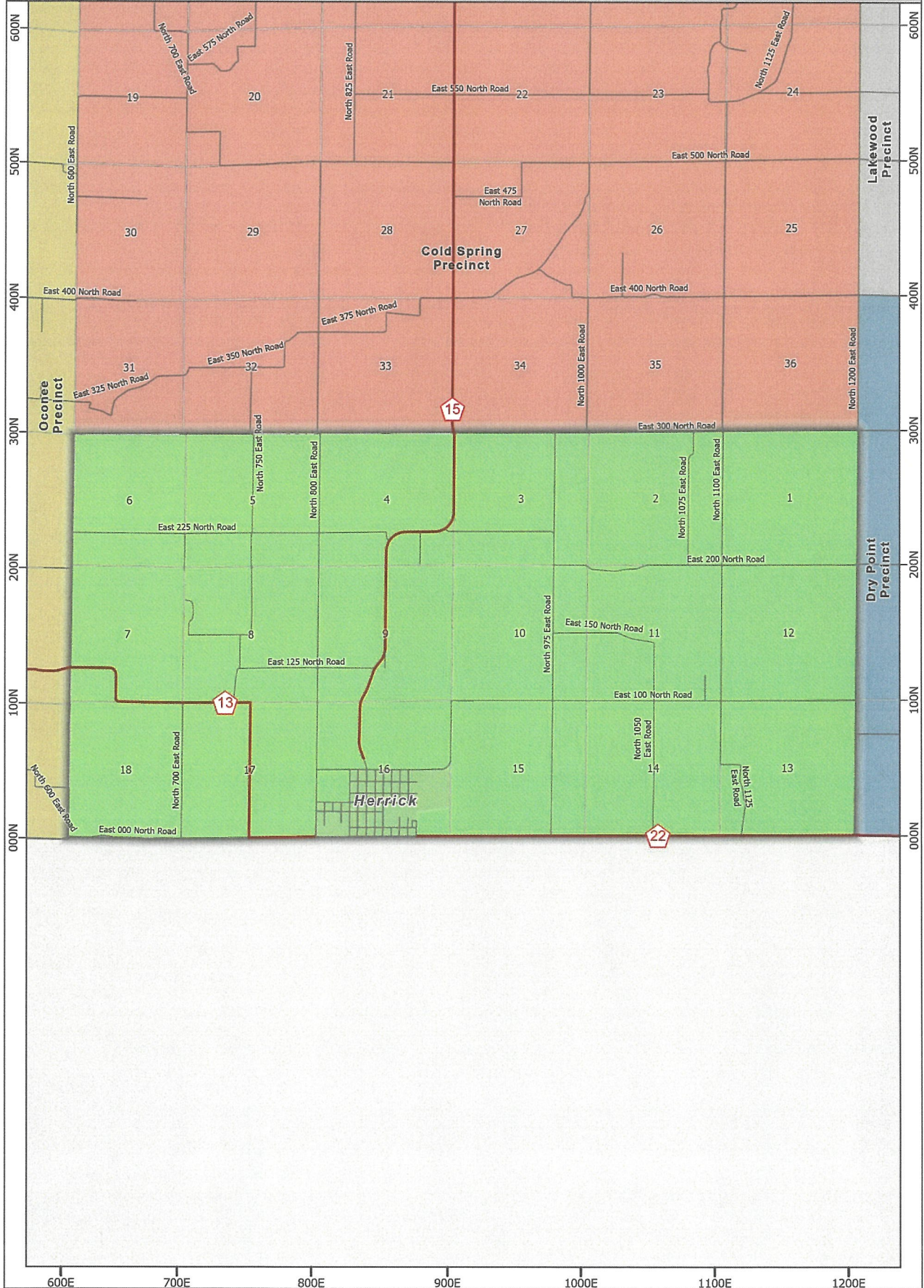
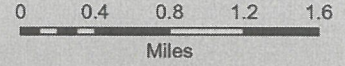

Shelby County Clerk/Recorder
301 E. Main St. PO Box 230
Shelbyville, IL 62565

Map Produced by:
Bruce Harris & Associates, Inc.
21 N. River St.
Batavia, IL 60510
www.bruceharris.com

August 2022

HOLLAND PRECINCT

Shelby County Clerk

| | |
|----------------------|---------------------|
| Precincts | Hydrography |
| Sections | Political Townships |
| Corporate Boundaries | |

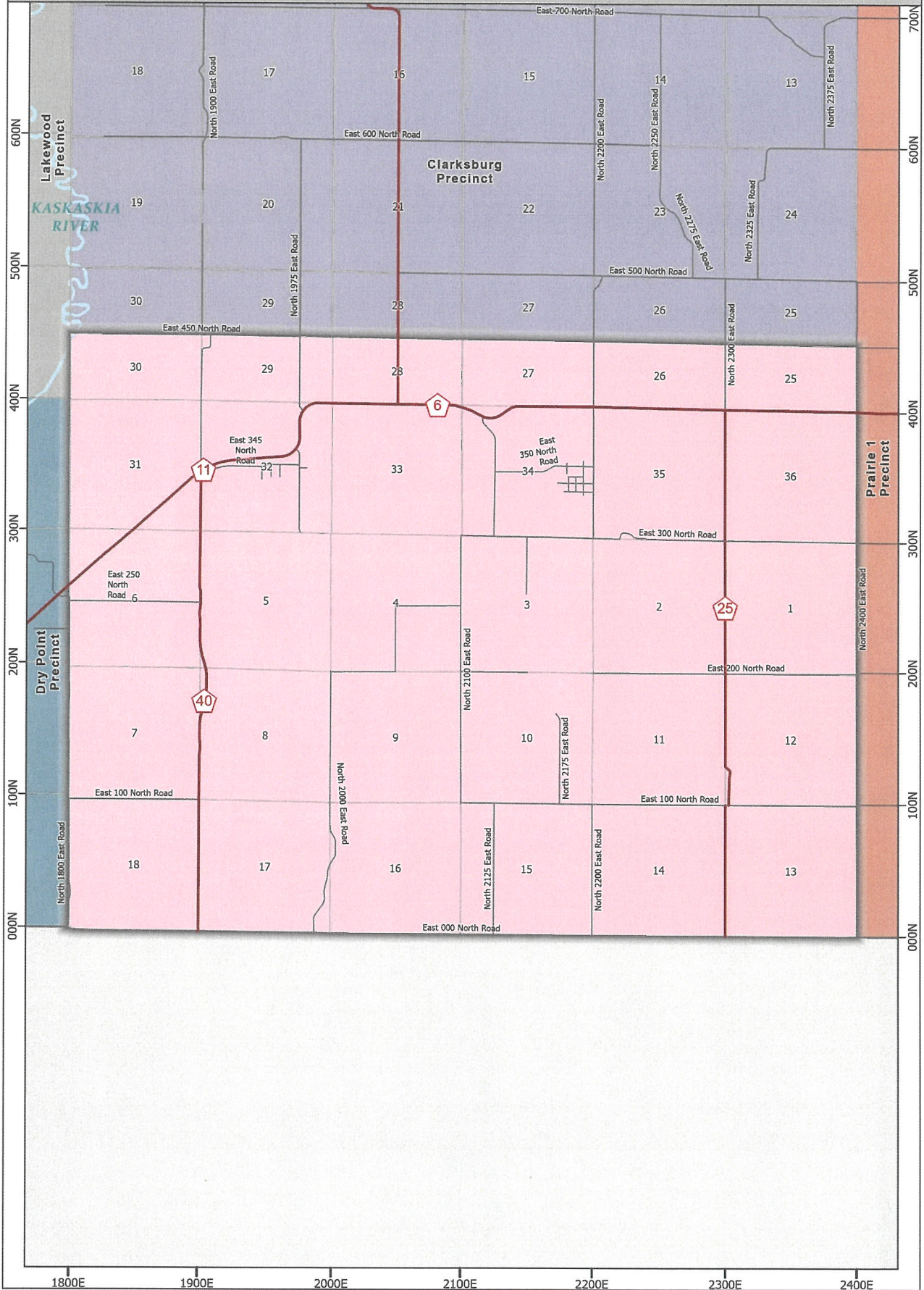

Shelby County Clerk/Recorder
301 E. Main St. PO Box 230
Shelbyville, IL 62565

Map Produced by:
Bruce Harris & Associates, Inc.
21 N. River St.
Batavia, IL 60510
www.bruceharris.com

August 2022

LAKESWOOD PRECINCT

Shelby County Clerk

| | |
|----------------------|---------------------|
| Precincts | Hydrography |
| Sections | Political Townships |
| Corporate Boundaries | |

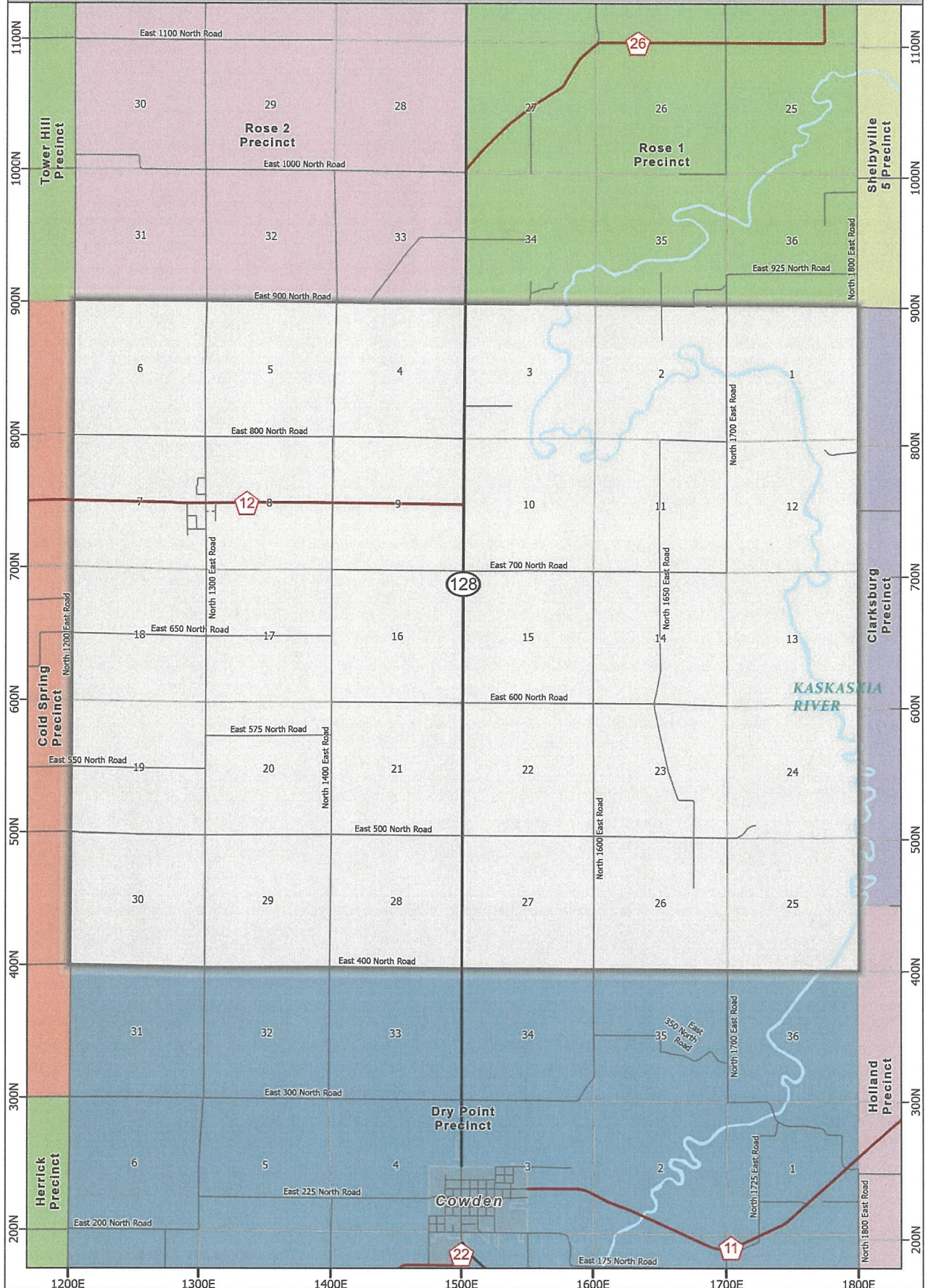
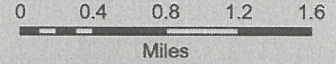

Shelby County Clerk/Recorder
301 E. Main St. PO Box 230
Shelbyville, IL 62565

Map Produced by:
Bruce Harris & Associates, Inc.
21 N. River St.
Batavia, IL 60510
www.bruceharris.com

August 2022

MOWEAQUA 1 PRECINCT

Shelby County Clerk

| | |
|----------------------|---------------------|
| Precincts | Hydrography |
| Sections | Political Townships |
| Corporate Boundaries | |

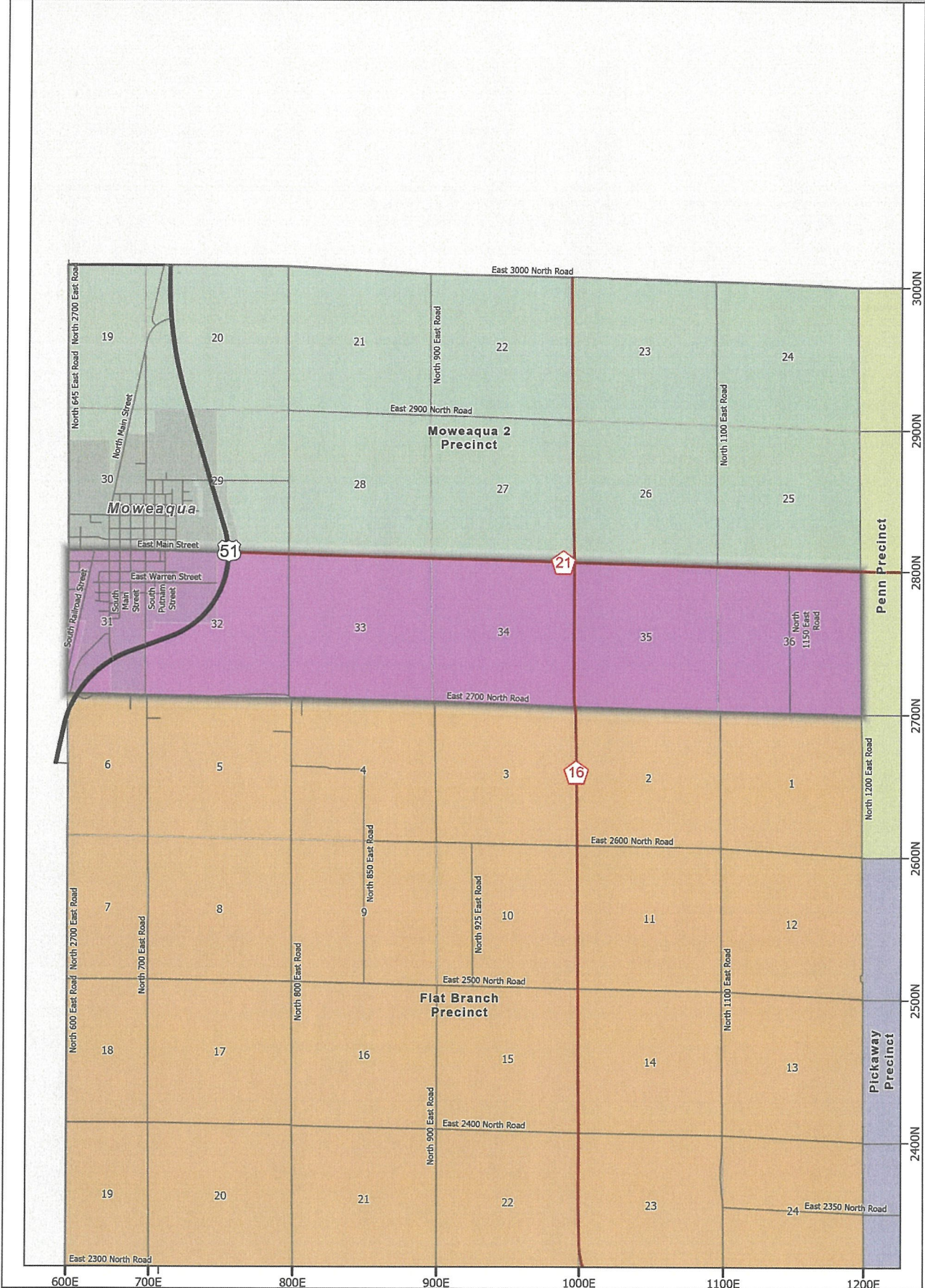
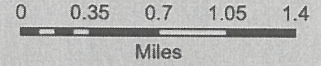

Shelby County Clerk/Recorder
301 E. Main St. PO Box 230
Shelbyville, IL 62565

Map Produced by:
Bruce Harris & Associates, Inc.
21 N. River St.
Batavia, IL 60510
www.bruceharris.com

August 2022

MOWEAQUA 2 PRECINCT

Shelby County Clerk

| | |
|----------------------|---------------------|
| Precincts | Hydrography |
| Sections | Political Townships |
| Corporate Boundaries | |

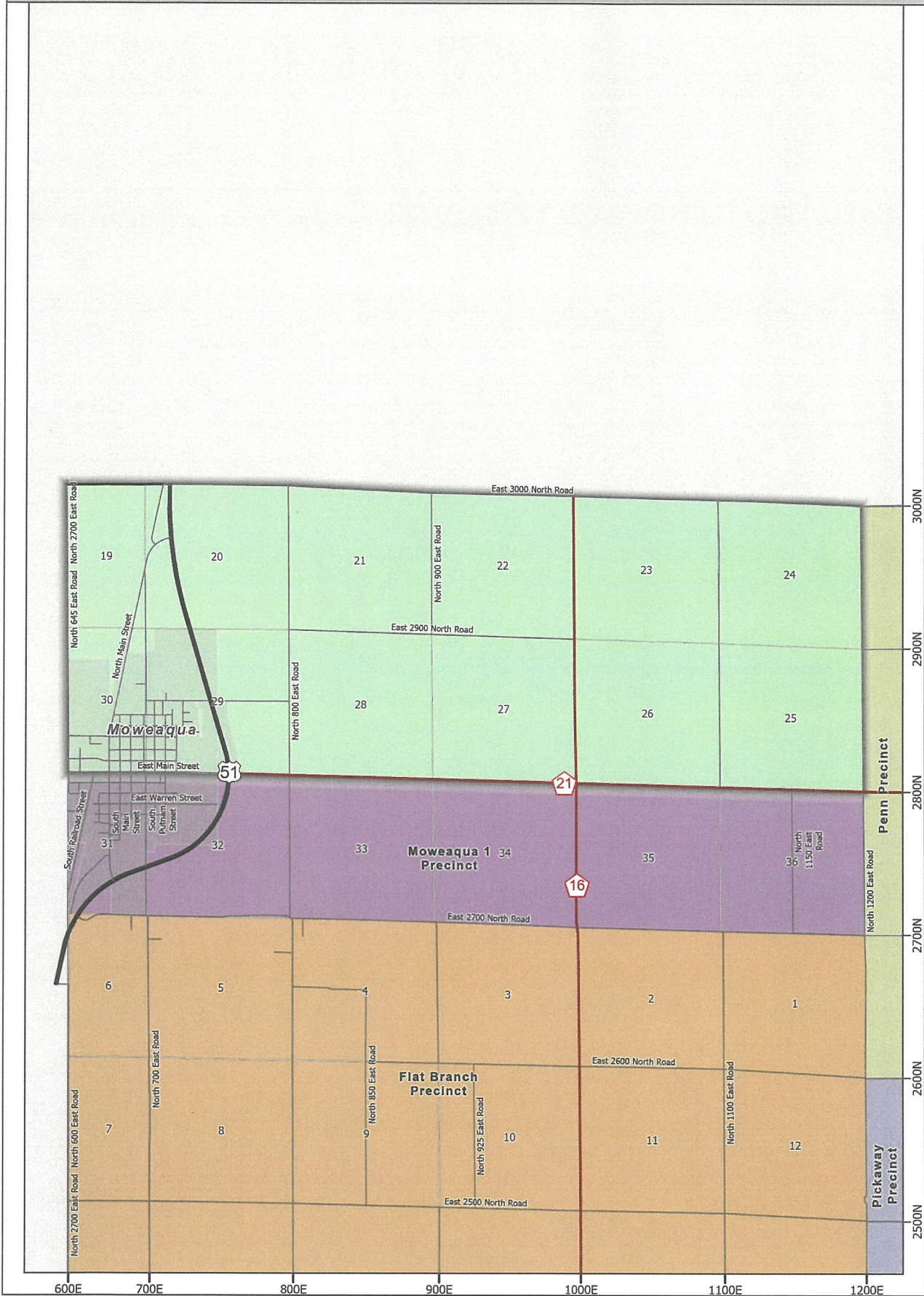
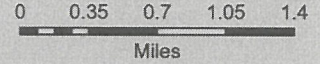

Shelby County Clerk/Recorder
301 E. Main St. PO Box 230
Shelbyville, IL 62565

Map Produced by:
Bruce Harris & Associates, Inc.
21 N. River St.
Batavia, IL 60510
www.bruceharris.com

August 2022

OCONEE PRECINCT

Shelby County Clerk

| | |
|----------------------|---------------------|
| Precincts | Hydrography |
| Sections | Political Townships |
| Corporate Boundaries | |

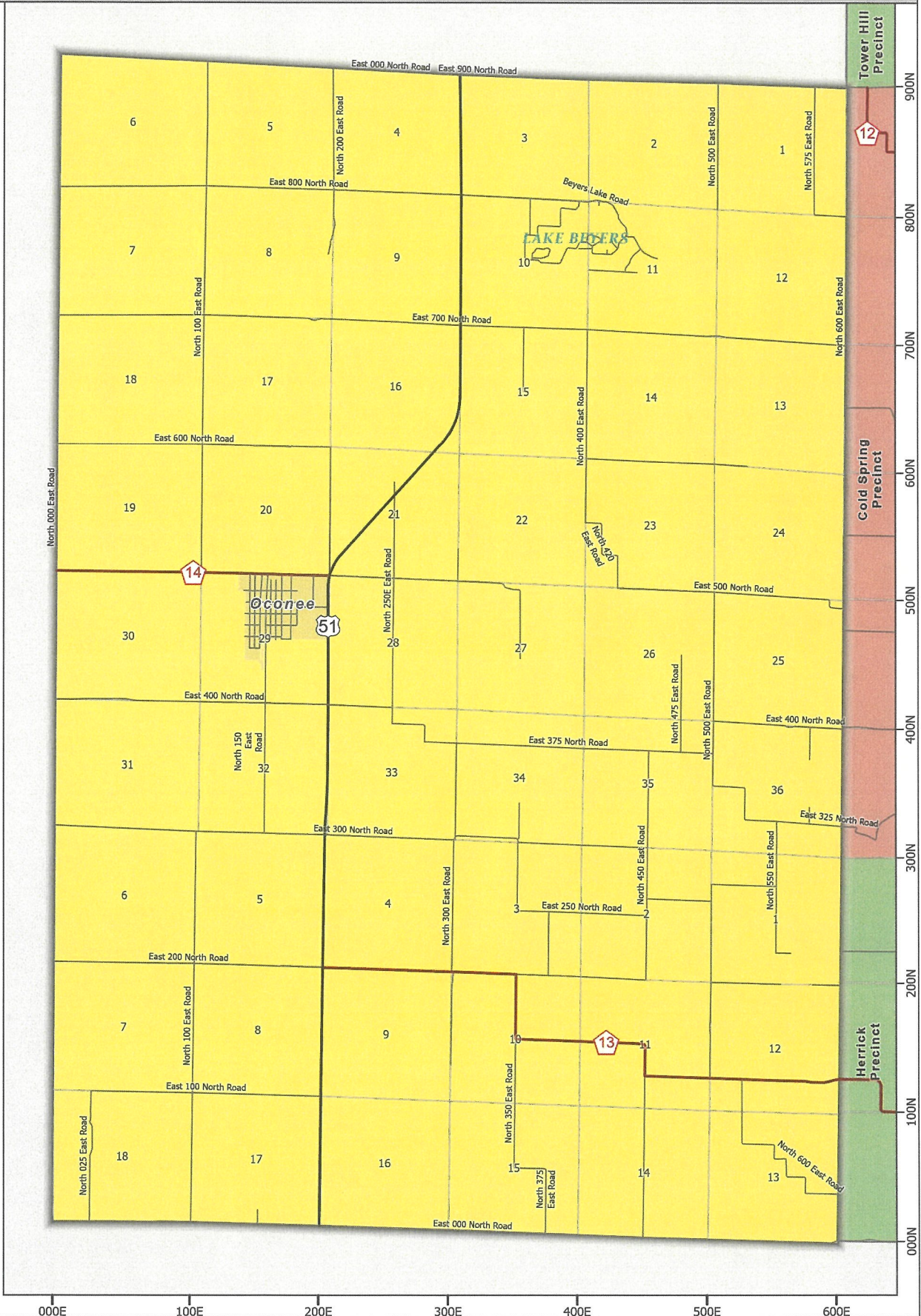
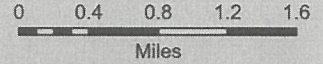

Shelby County Clerk/Recorder
301 E. Main St. PO Box 230
Shelbyville, IL 62565

Map Produced by:
Bruce Harris & Associates, Inc.
21 N. River St.
Batavia, IL 60510
www.bruceharris.com

August 2022

OKAW PRECINCT

Shelby County Clerk

| | |
|----------------------|---------------------|
| Precincts | Hydrography |
| Sections | Political Townships |
| Corporate Boundaries | |

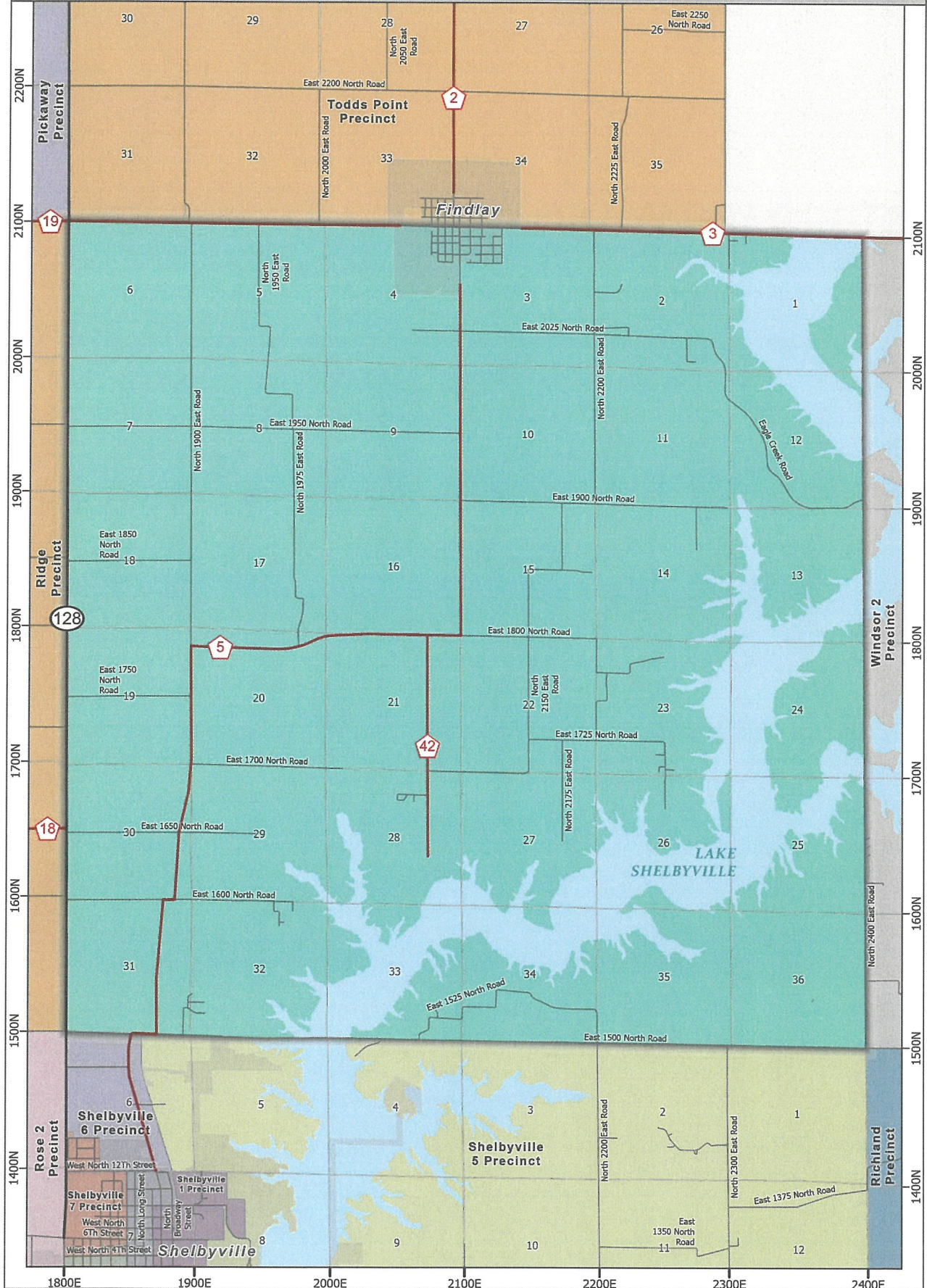
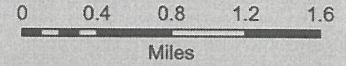

Shelby County Clerk/Recorder
301 E. Main St. PO Box 230
Shelbyville, IL 62565

Map Produced by:
Bruce Harris & Associates, Inc.
21 N. River St.
Batavia, IL 60510
www.bruceharris.com

August 2022

PENN PRECINCT

Shelby County Clerk

| | |
|----------------------|---------------------|
| Precincts | Hydrography |
| Sections | Political Townships |
| Corporate Boundaries | |

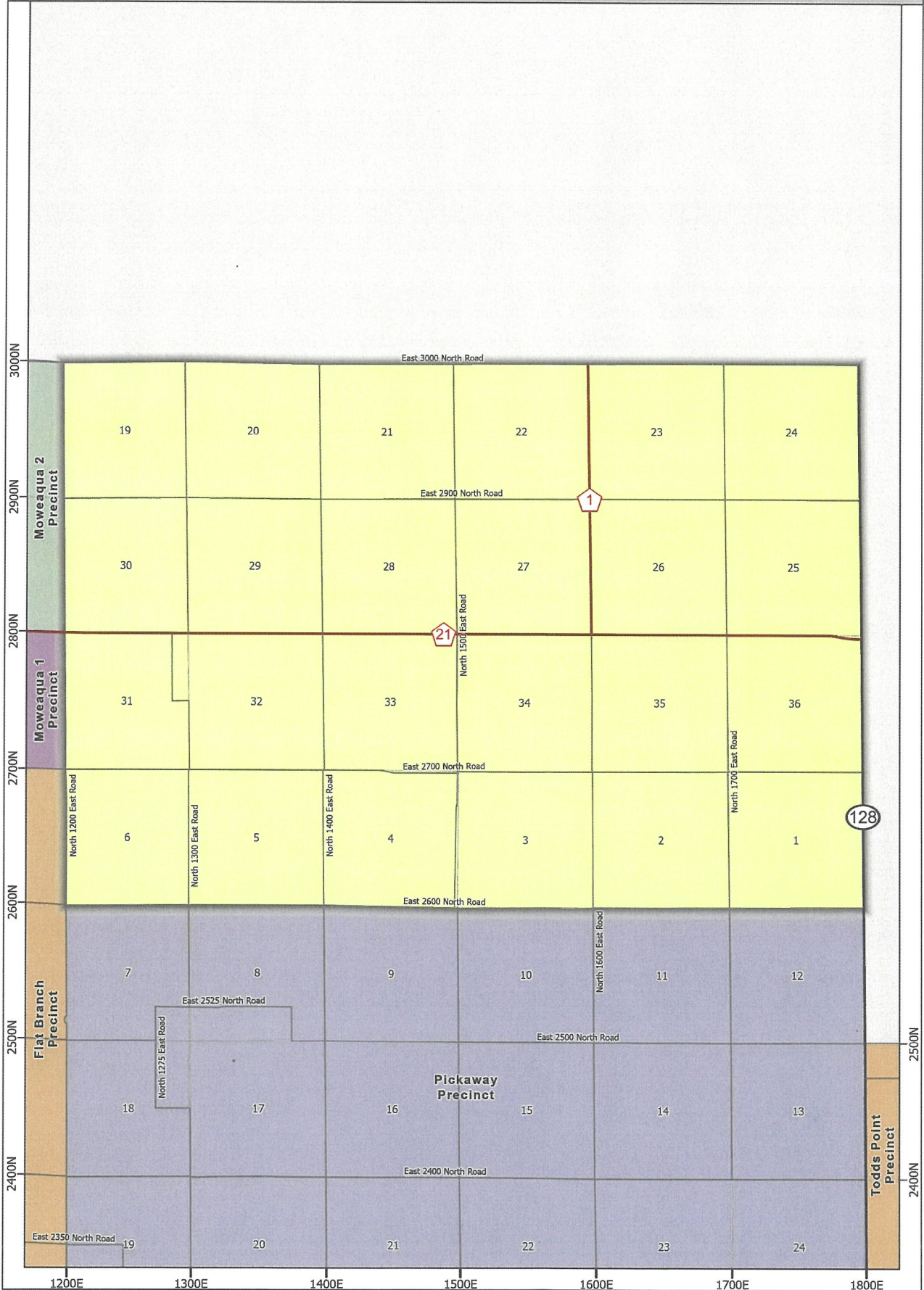
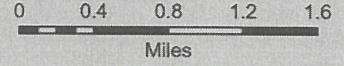

Shelby County Clerk/Recorder
301 E. Main St. PO Box 230
Shelbyville, IL 62565

Map Produced by:
Bruce Harris & Associates, Inc.
21 N. River St.
Batavia, IL 60510
www.bruceharris.com

August 2022

PICKAWAY PRECINCT

Shelby County Clerk

| | |
|----------------------|---------------------|
| Precincts | Hydrography |
| Sections | Political Townships |
| Corporate Boundaries | |

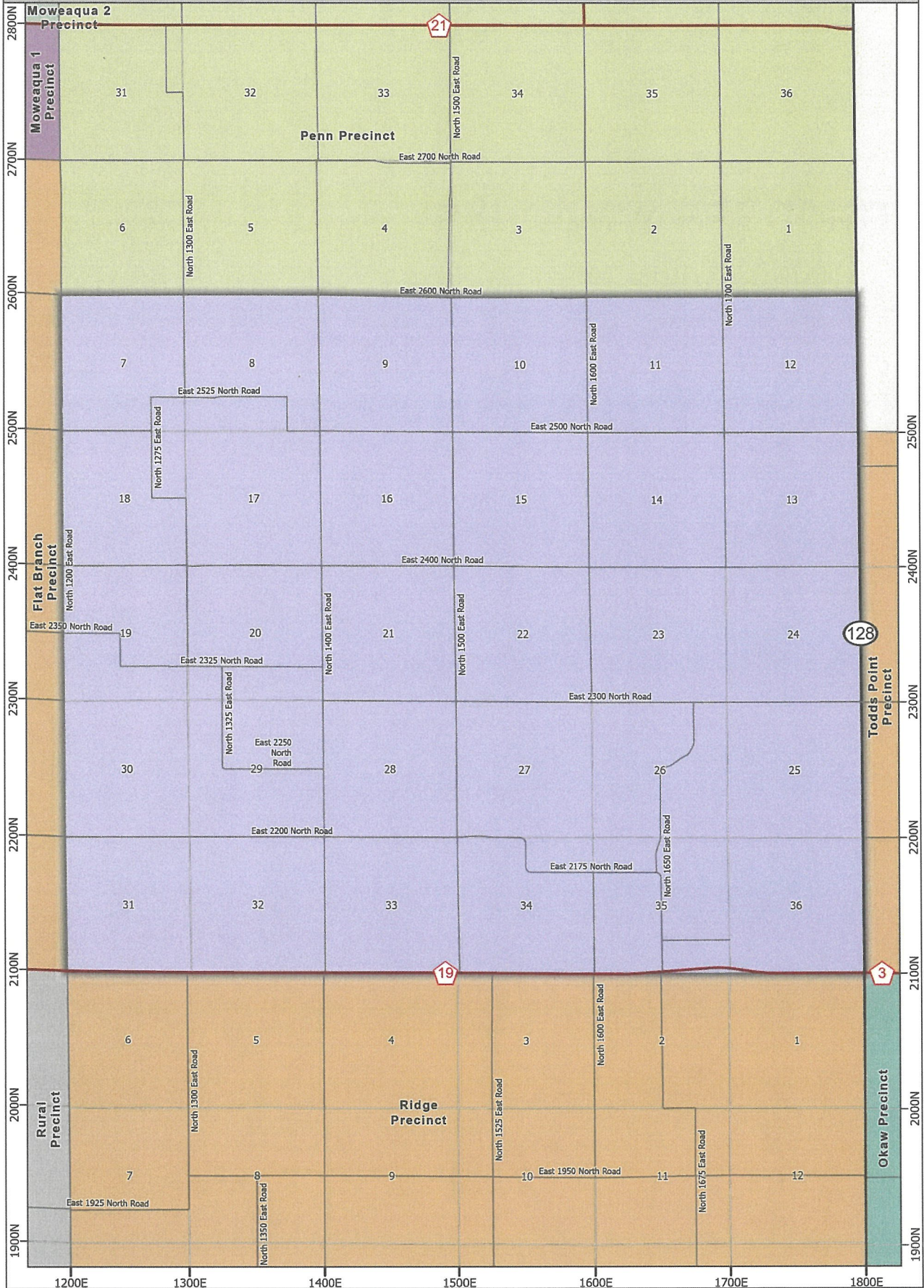
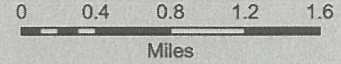

Shelby County Clerk/Recorder
301 E. Main St. PO Box 230
Shelbyville, IL 62565

Map Produced by:
Bruce Harris & Associates, Inc.
21 N. River St.
Batavia, IL 60510
www.bruceharris.com

August 2022

PRAIRIE 1 PRECINCT

Shelby County Clerk

| | |
|----------------------|---------------------|
| Precincts | Hydrography |
| Sections | Political Townships |
| Corporate Boundaries | |

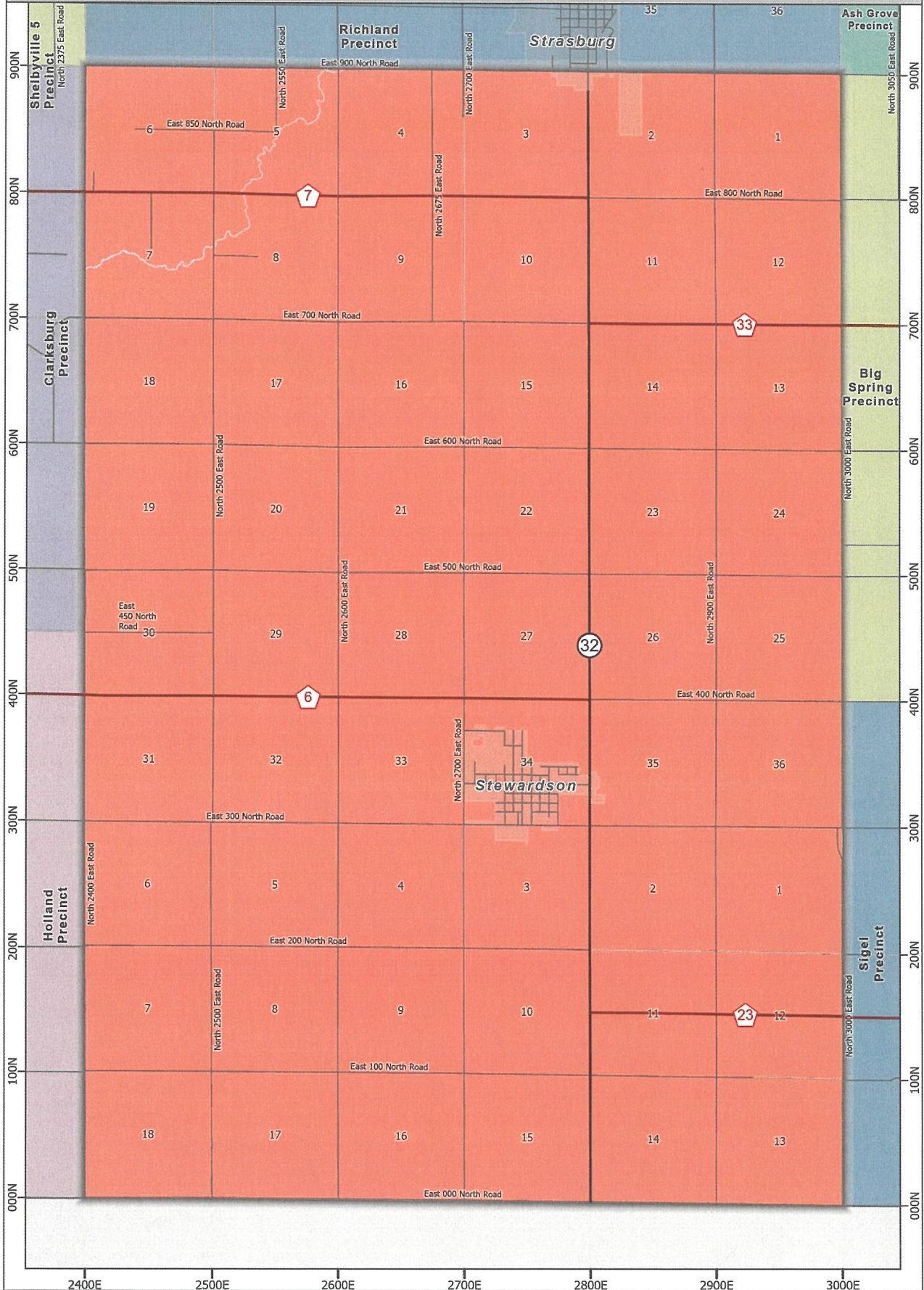

Shelby County Clerk/Recorder
301 E. Main St. PO Box 230
Shelbyville, IL 62565

Map Produced by:
Bruce Harris & Associates, Inc.
21 N. River St.
Batavia, IL 60510
www.bruceharris.com

August 2022

RICHLAND PRECINCT

Shelby County Clerk

| | |
|----------------------|---------------------|
| Precincts | Hydrography |
| Sections | Political Townships |
| Corporate Boundaries | |

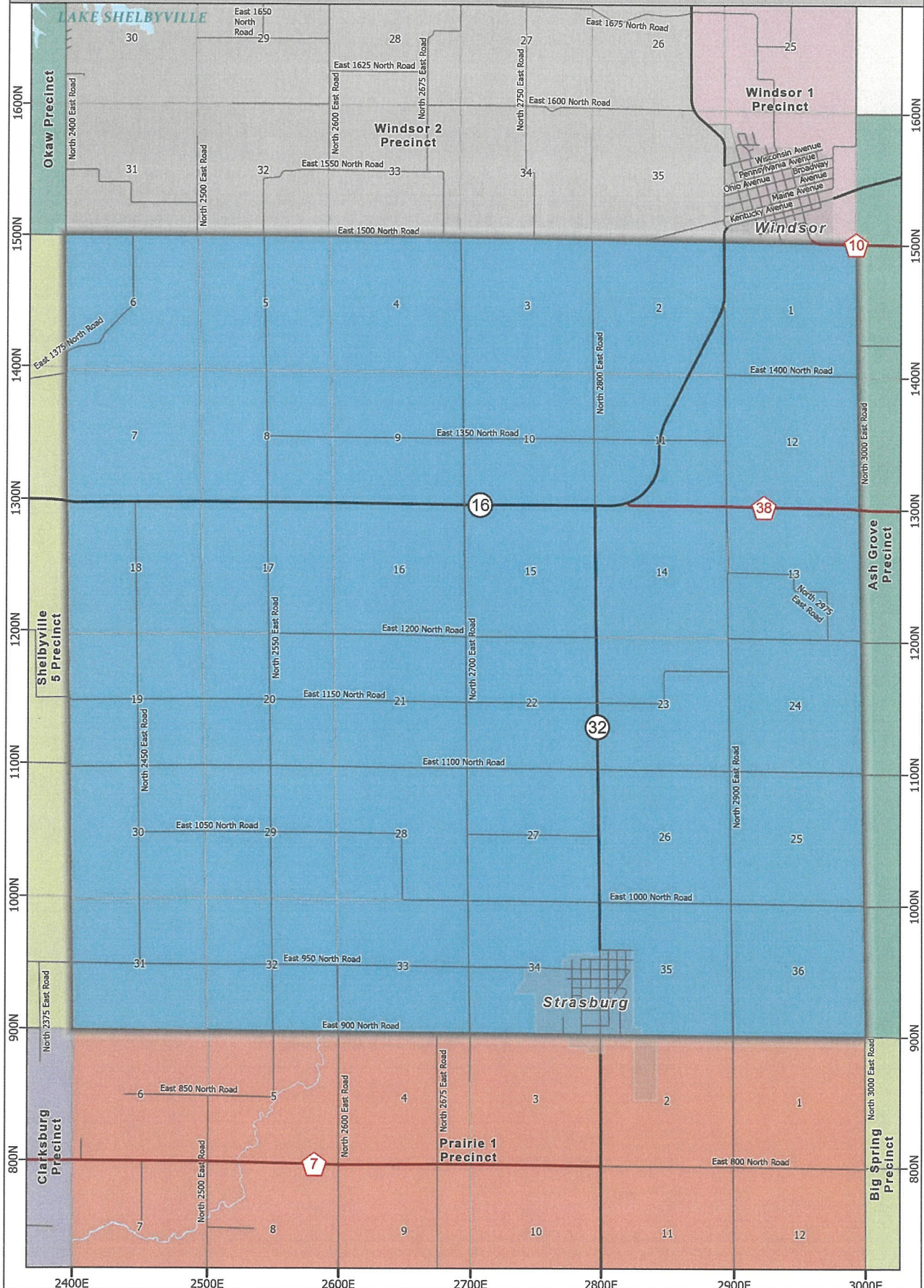
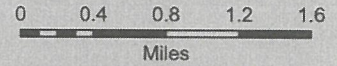

Shelby County Clerk/Recorder
301 E. Main St, PO Box 230
Shelbyville, IL 62565

Map Produced by:
Bruce Harris & Associates, Inc.
21 N. River St.
Batavia, IL 60510
www.bruceharris.com

August 2022

RIDGE PRECINCT

Shelby County Clerk

| | | | |
|--|----------------------|--|---------------------|
| | Precincts | | Hydrography |
| | Sections | | Political Townships |
| | Corporate Boundaries | | |

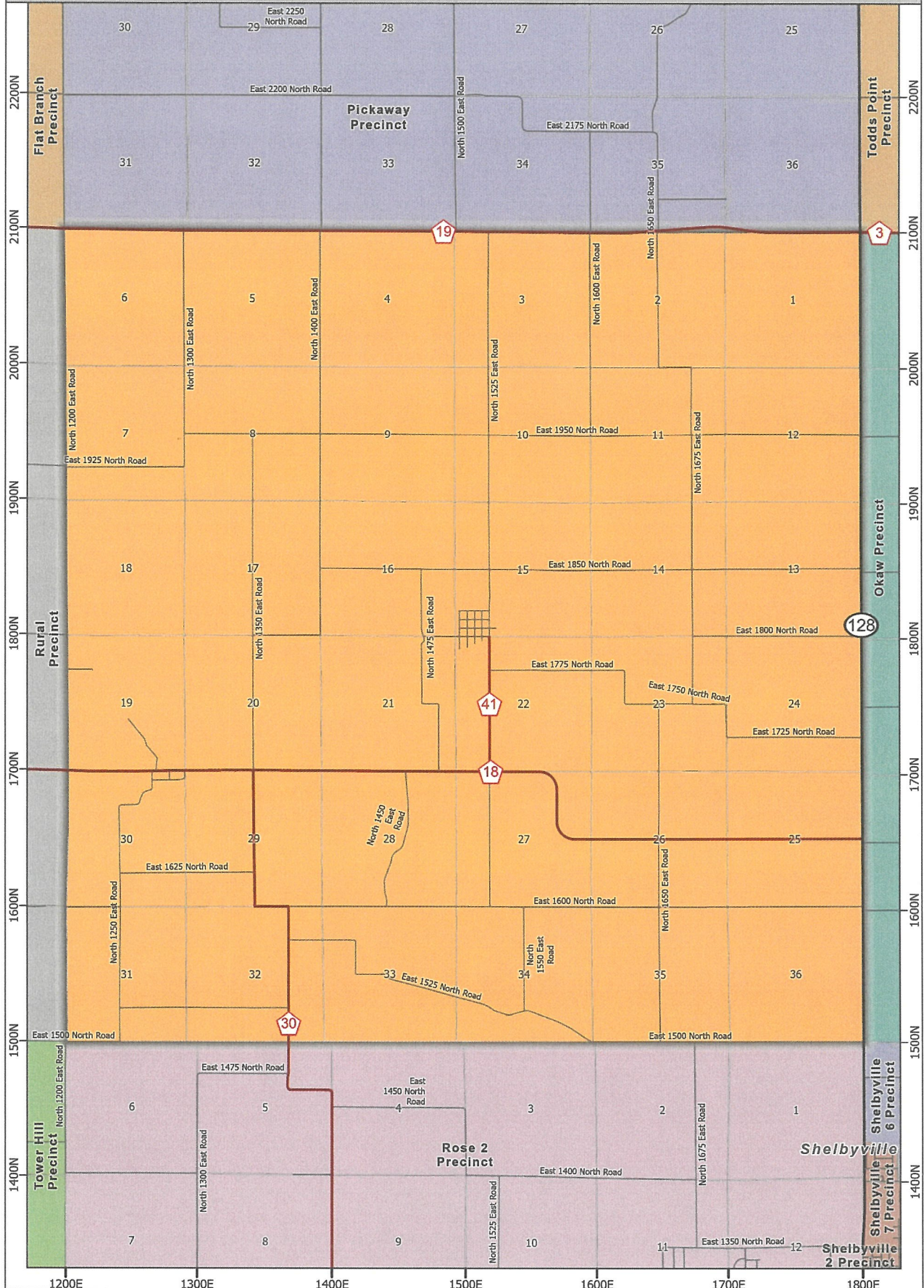
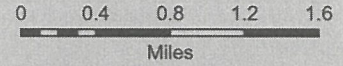

Shelby County Clerk/Recorder
301 E. Main St. PO Box 230
Shelbyville, IL 62565

Map Produced by:
Bruce Harris & Associates, Inc.
21 N. River St.
Batavia, IL 60510
www.bruceharris.com

August 2022

ROSE 1 PRECINCT

Shelby County Clerk

| | |
|----------------------|---------------------|
| Precincts | Hydrography |
| Sections | Political Townships |
| Corporate Boundaries | |

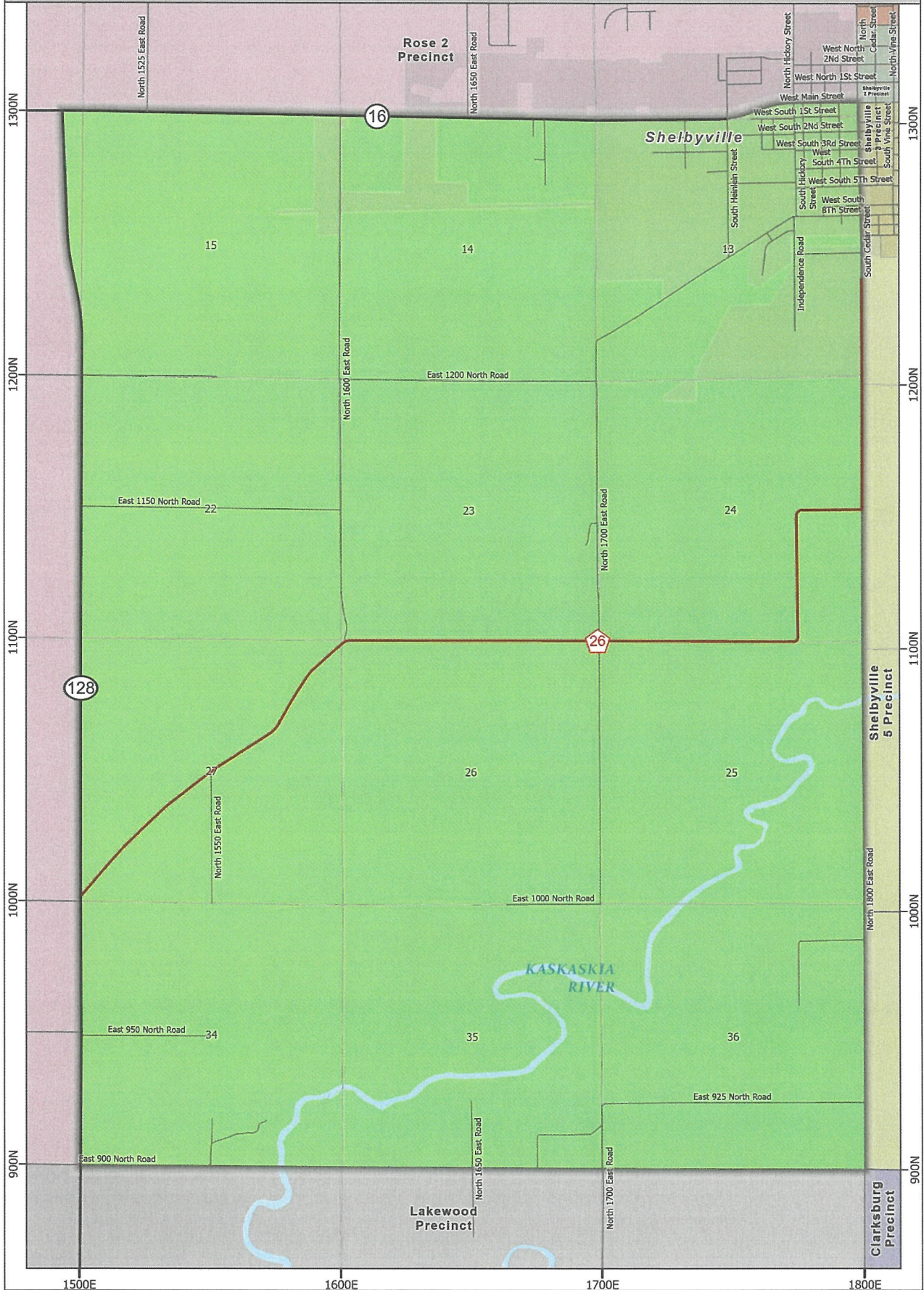
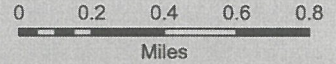

Shelby County Clerk/Recorder
301 E. Main St. PO Box 230
Shelbyville, IL 62565

Map Produced by:
Bruce Harris & Associates, Inc.
21 N. River St.
Batavia, IL 60510
www.bruceharris.com

August 2022

ROSE 2 PRECINCT

Shelby County Clerk

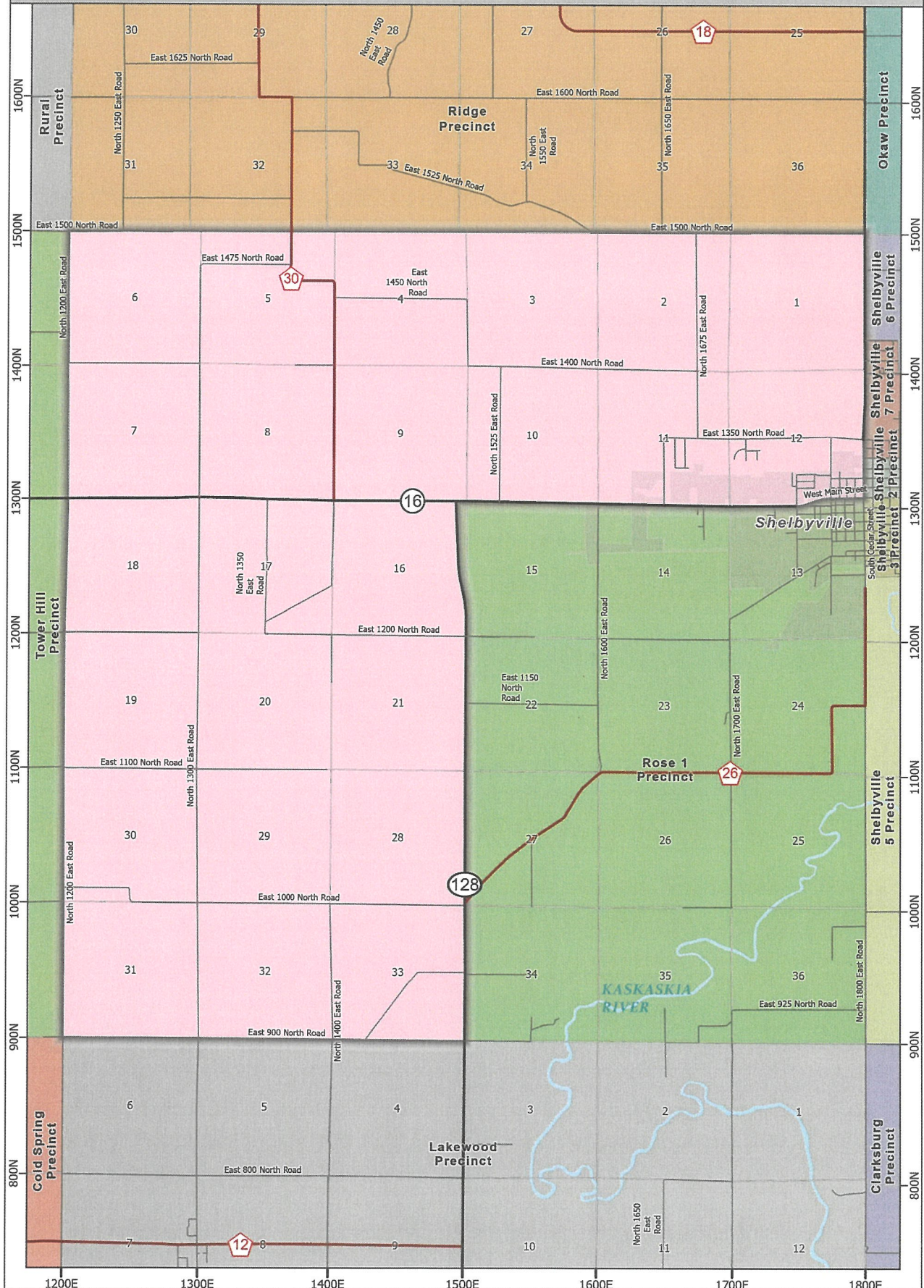
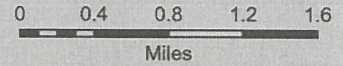
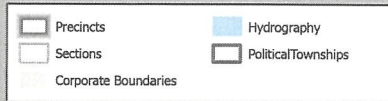

Shelby County Clerk/Recorder
301 E. Main St. PO Box 230
Shelbyville, IL 62565

Map Produced by:
Bruce Harris & Associates, Inc.
21 N. River St.
Batavia, IL 60510
www.bruceharris.com

August 2022

RURAL PRECINCT

Shelby County Clerk

| | | | |
|--|----------------------|--|---------------------|
| | Precincts | | Hydrography |
| | Sections | | Political Townships |
| | Corporate Boundaries | | |

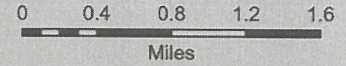

Shelby County Clerk/Recorder
301 E. Main St. PO Box 230
Shelbyville, IL 62565

Map Produced by:
Bruce Harris & Associates, Inc.
21 N. River St.
Batavia, IL 60510
www.bruceharris.com

August 2022

SHELBYVILLE 1 PRECINCT

Shelby County Clerk

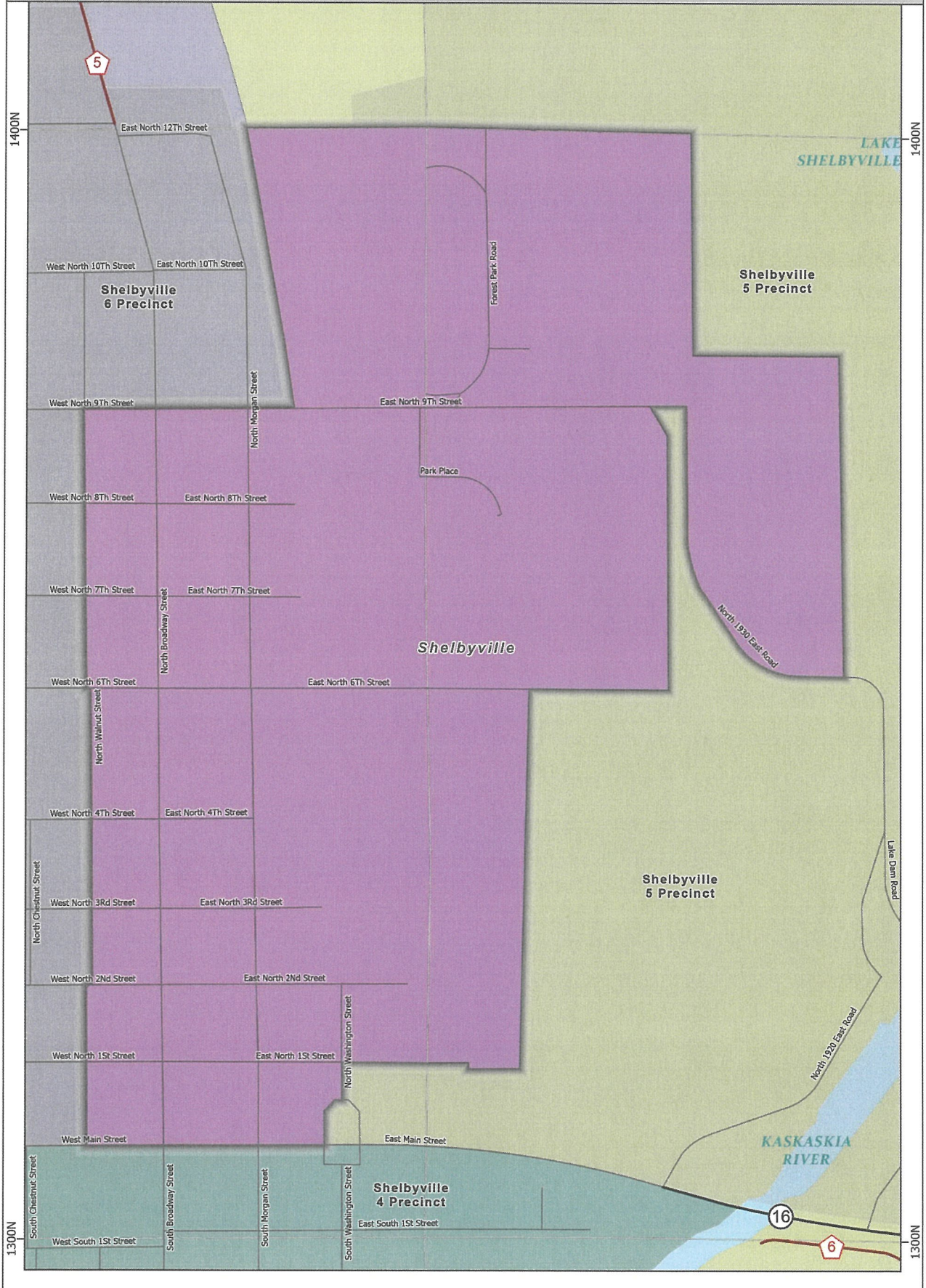
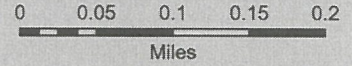
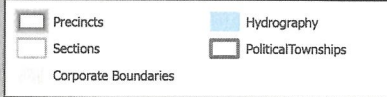

Shelby County Clerk/Recorder
301 E. Main St. PO Box 230
Shelbyville, IL 62565

Map Produced by:
Bruce Harris & Associates, Inc.
21 N. River St.
Batavia, IL 60510
www.bruceharris.com

August 2022

SHELBYVILLE 2 PRECINCT

Shelby County Clerk

| | | | |
|---|-----------|---|---------------------|
|  | Precincts |  | Hydrography |
|  | Sections |  | Political Townships |
| Corporate Boundaries | | | |

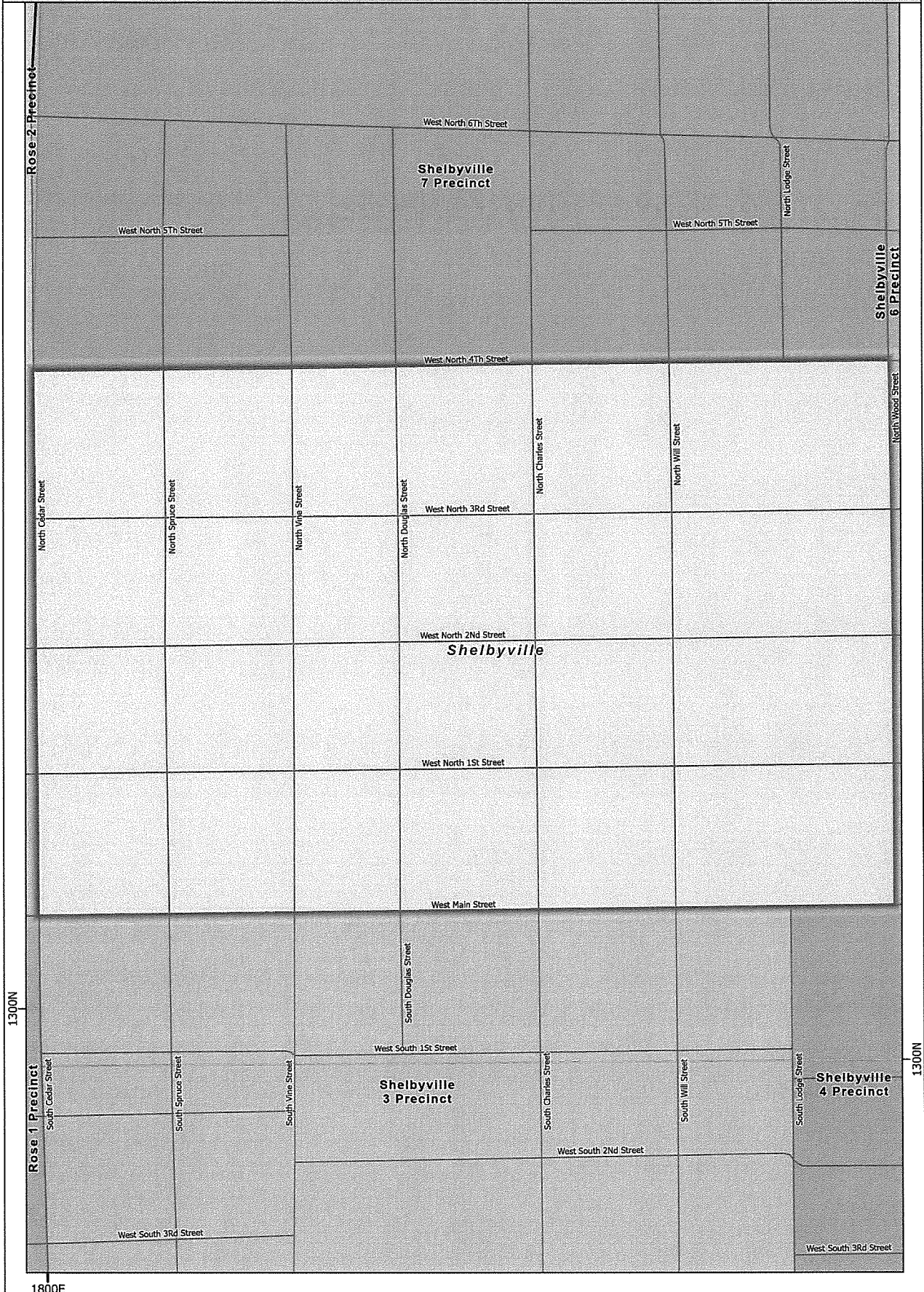
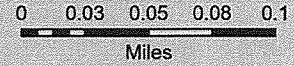

Shelby County Clerk/Recorder
301 E. Main St. PO Box 230
Shelbyville, IL 62565

Map Produced by:
Bruce Harris & Associates, Inc.
21 N. River St.
Batavia, IL 60510
www.bruceharris.com

August 2022

SHELBYVILLE 3 PRECINCT

Shelby County Clerk

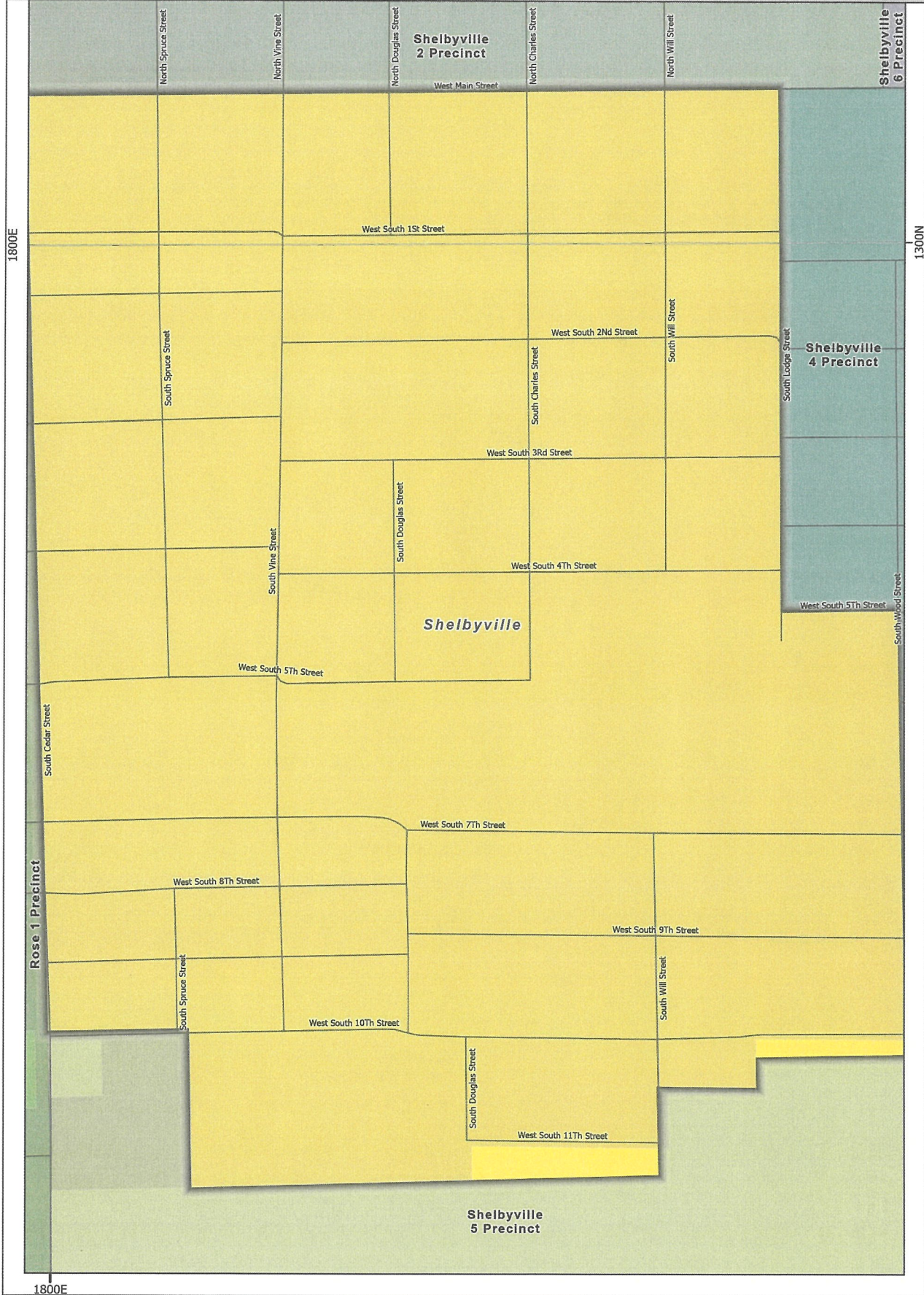
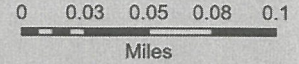
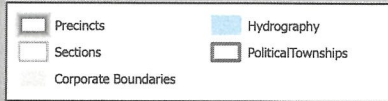

Shelby County Clerk/Recorder
301 E. Main St. PO Box 230
Shelbyville, IL 62565

Map Produced by:
Bruce Harris & Associates, Inc.
21 N. River St.
Batavia, IL 60510
www.bruceharris.com

August 2022

SHELBYVILLE 4 PRECINCT

Shelby County Clerk

| | |
|----------------------|---------------------|
| Precincts | Hydrography |
| Sections | Political Townships |
| Corporate Boundaries | |

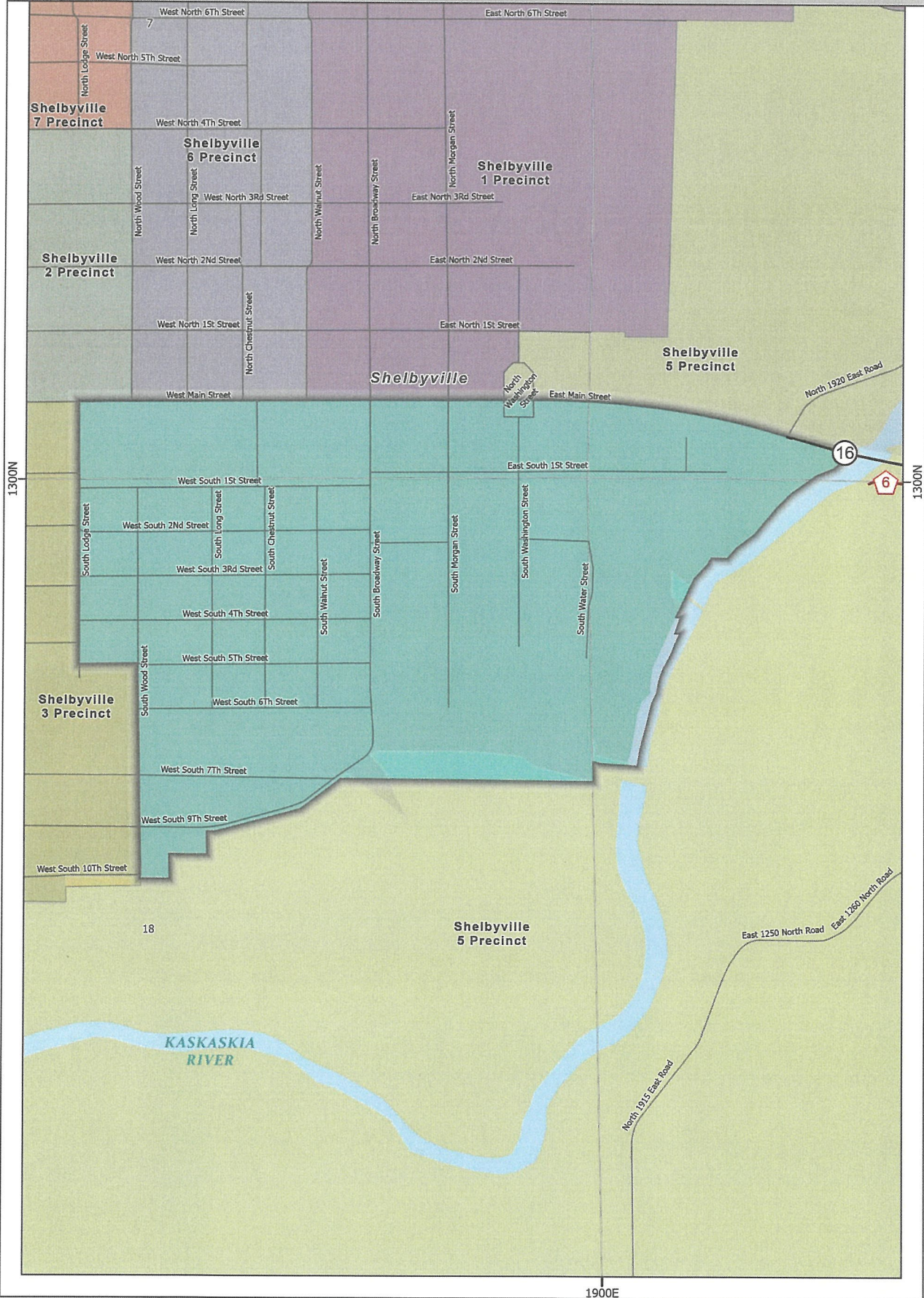
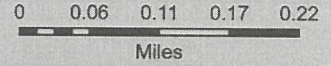

Shelby County Clerk/Recorder
301 E. Main St. PO Box 230
Shelbyville, IL 62565

Map Produced by:
Bruce Harris & Associates, Inc.
21 N. River St.
Batavia, IL 60510
www.bruceharris.com

August 2022

SHELBYVILLE 5 PRECINCT

Shelby County Clerk

| | |
|----------------------|---------------------|
| Precincts | Hydrography |
| Sections | Political Townships |
| Corporate Boundaries | |

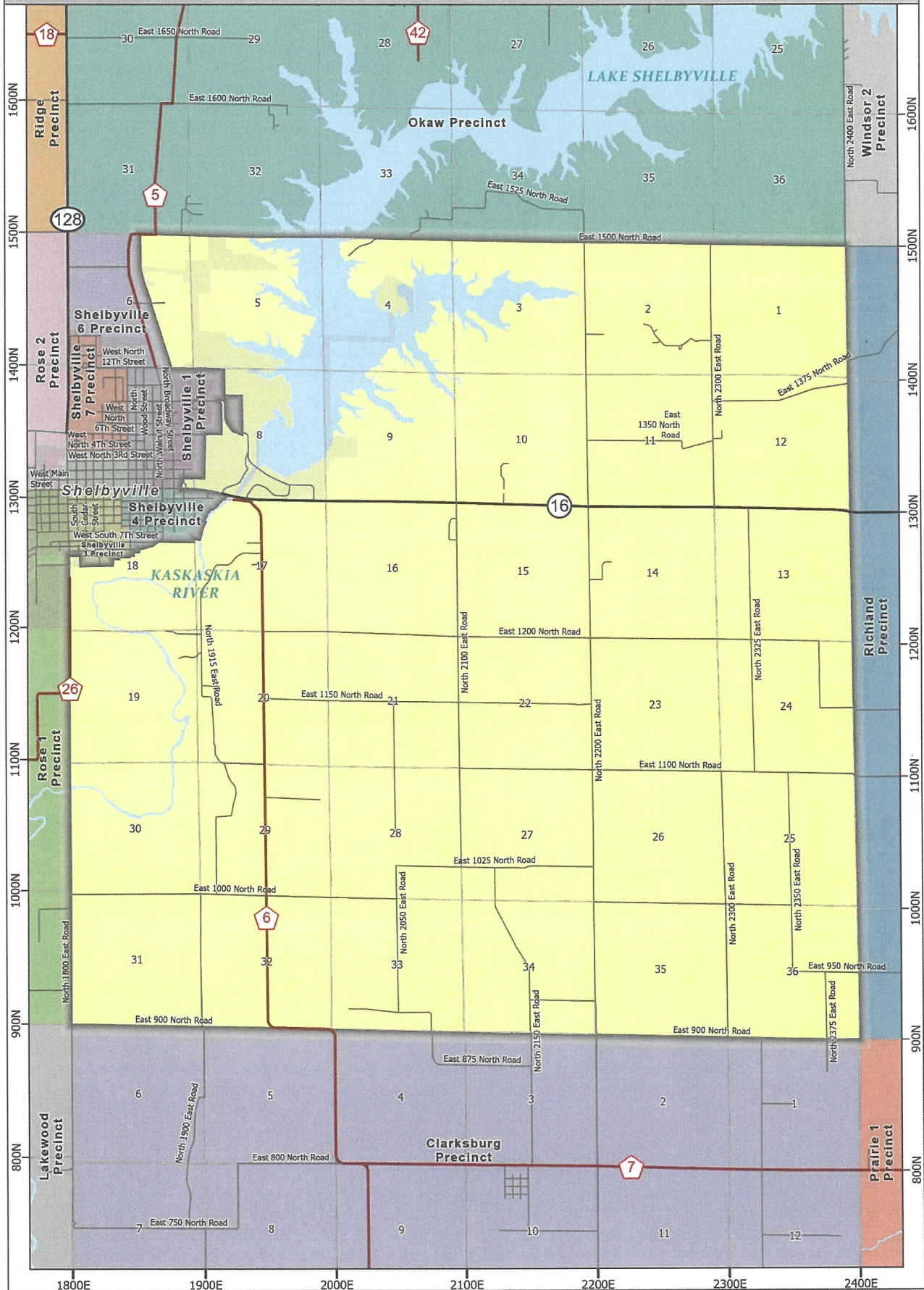
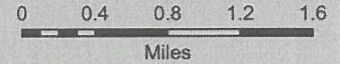

Shelby County Clerk/Recorder
301 E. Main St. PO Box 230
Shelbyville, IL 62565

Map Produced by:
Bruce Harris & Associates, Inc.
21 N. River St.
Batavia, IL 60510
www.bruceharris.com

August 2022

SHELBYVILLE 6 PRECINCT

Shelby County Clerk

| | |
|----------------------|---------------------|
| Precincts | Hydrography |
| Sections | Political Townships |
| Corporate Boundaries | |

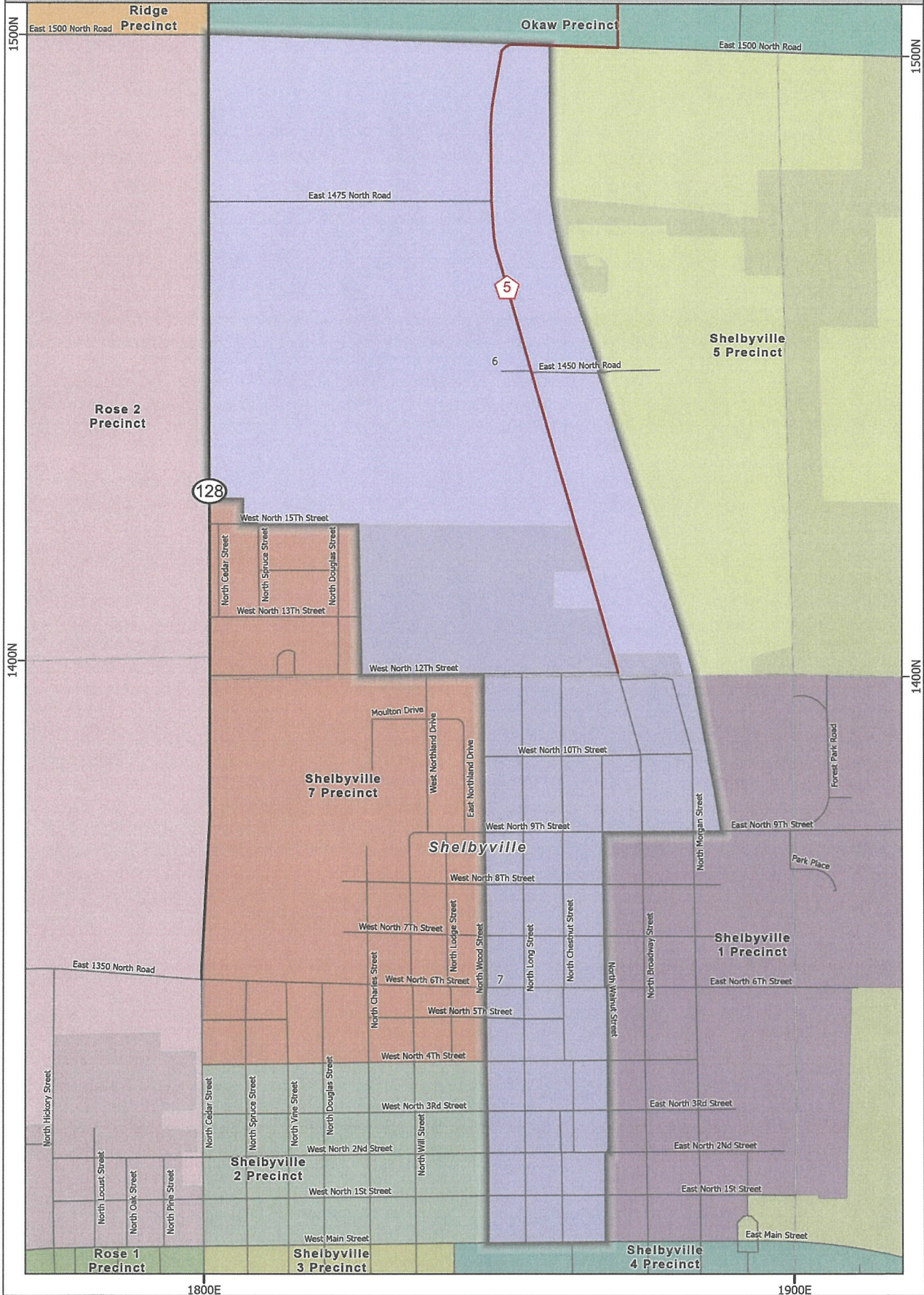
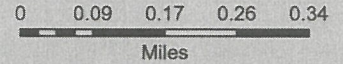





Shelby County Clerk/Recorder
301 E. Main St. PO Box 230
Shelbyville, IL 62565

Map Produced by:
Bruce Harris & Associates, Inc.
21 N. River St.
Batavia, IL 60510
www.bruceharris.com

August 2022

SHELBYVILLE 7 PRECINCT

Shelby County Clerk

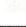
| | | | |
|---|----------------------|---|---------------------|
|  | Precincts |  | Hydrography |
|  | Sections |  | Political Townships |
|  | Corporate Boundaries | | |

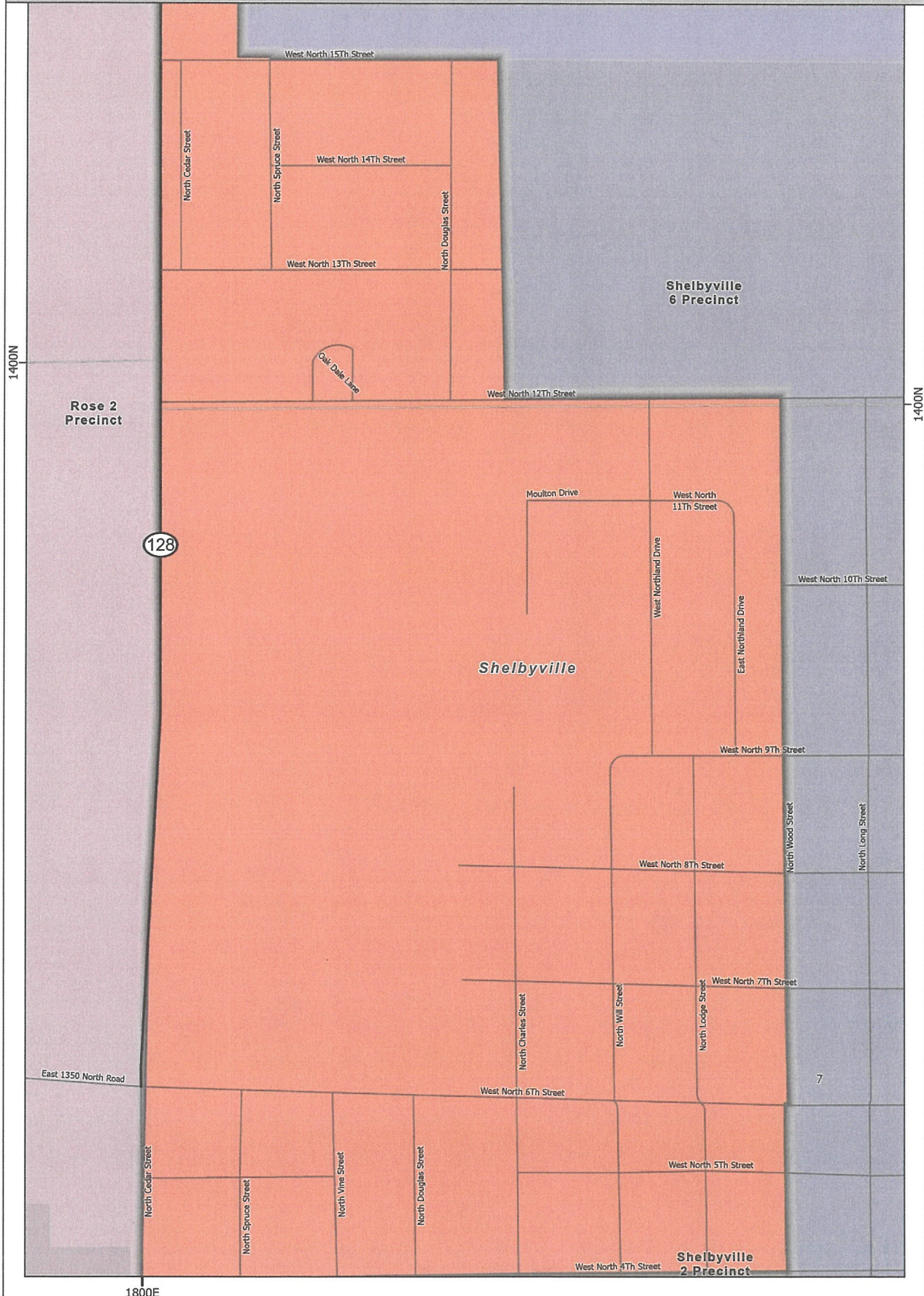
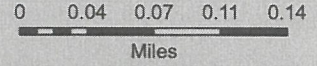

Shelby County Clerk/Recorder
301 E. Main St. PO Box 230
Shelbyville, IL 62565

Map Produced by:
Bruce Harris & Associates, Inc.
21 N. River St.
Batavia, IL 60510
www.bruceharris.com

August 2022

SIGEL PRECINCT

Shelby County Clerk

| | |
|----------------------|---------------------|
| Precincts | Hydrography |
| Sections | Political Townships |
| Corporate Boundaries | |

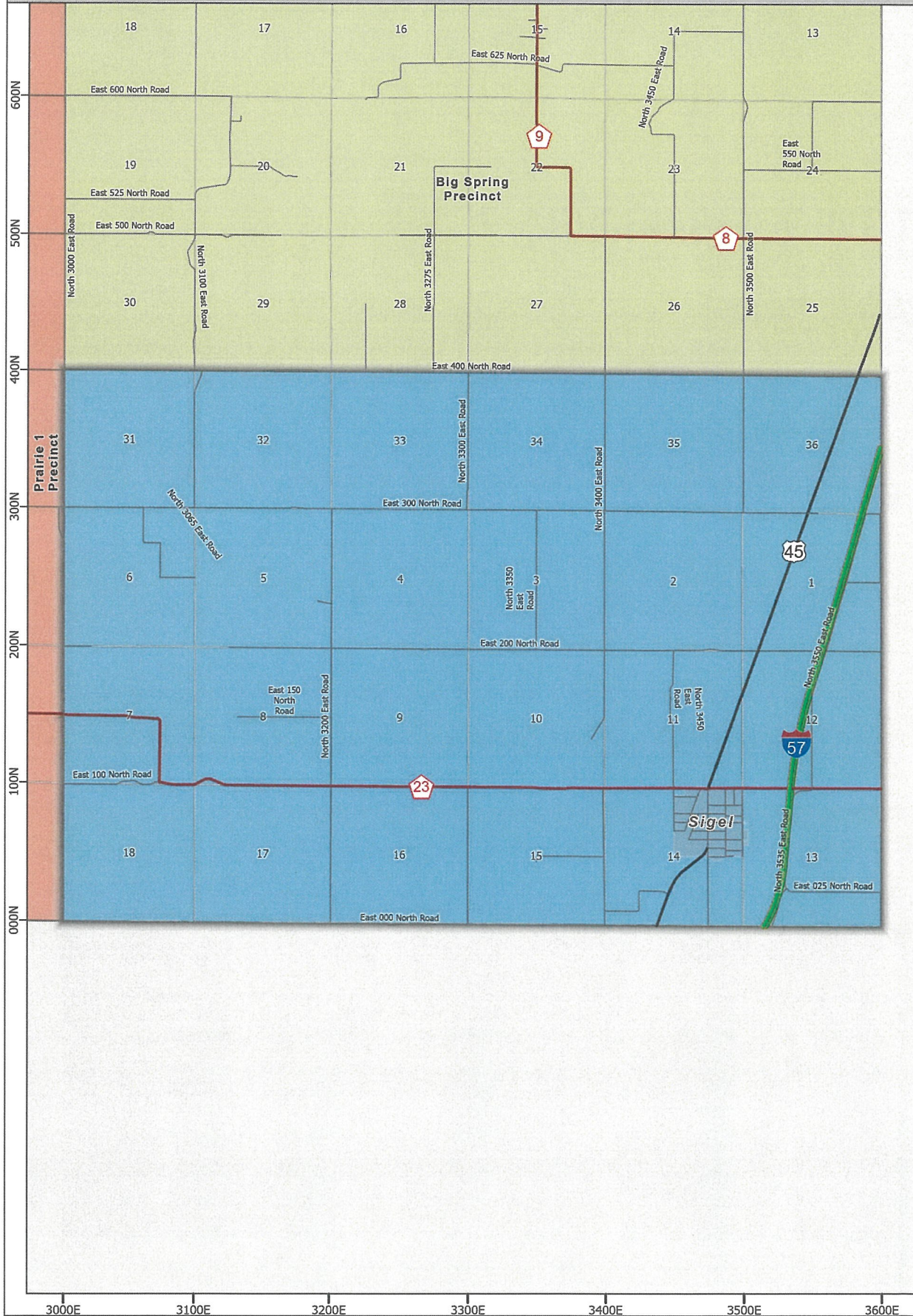
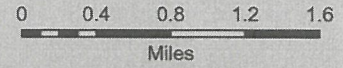



Shelby County Clerk/Recorder
301 E. Main St. PO Box 230
Shelbyville, IL 62565

Map Produced by:
Bruce Harris & Associates, Inc.
21 N. River St.
Batavia, IL 60510
www.bruceharris.com

August 2022

TODDS POINT PRECINCT

Shelby County Clerk

| | |
|---|---|
|  Precincts |  Hydrography |
|  Sections |  Political Townships |
| Corporate Boundaries | |

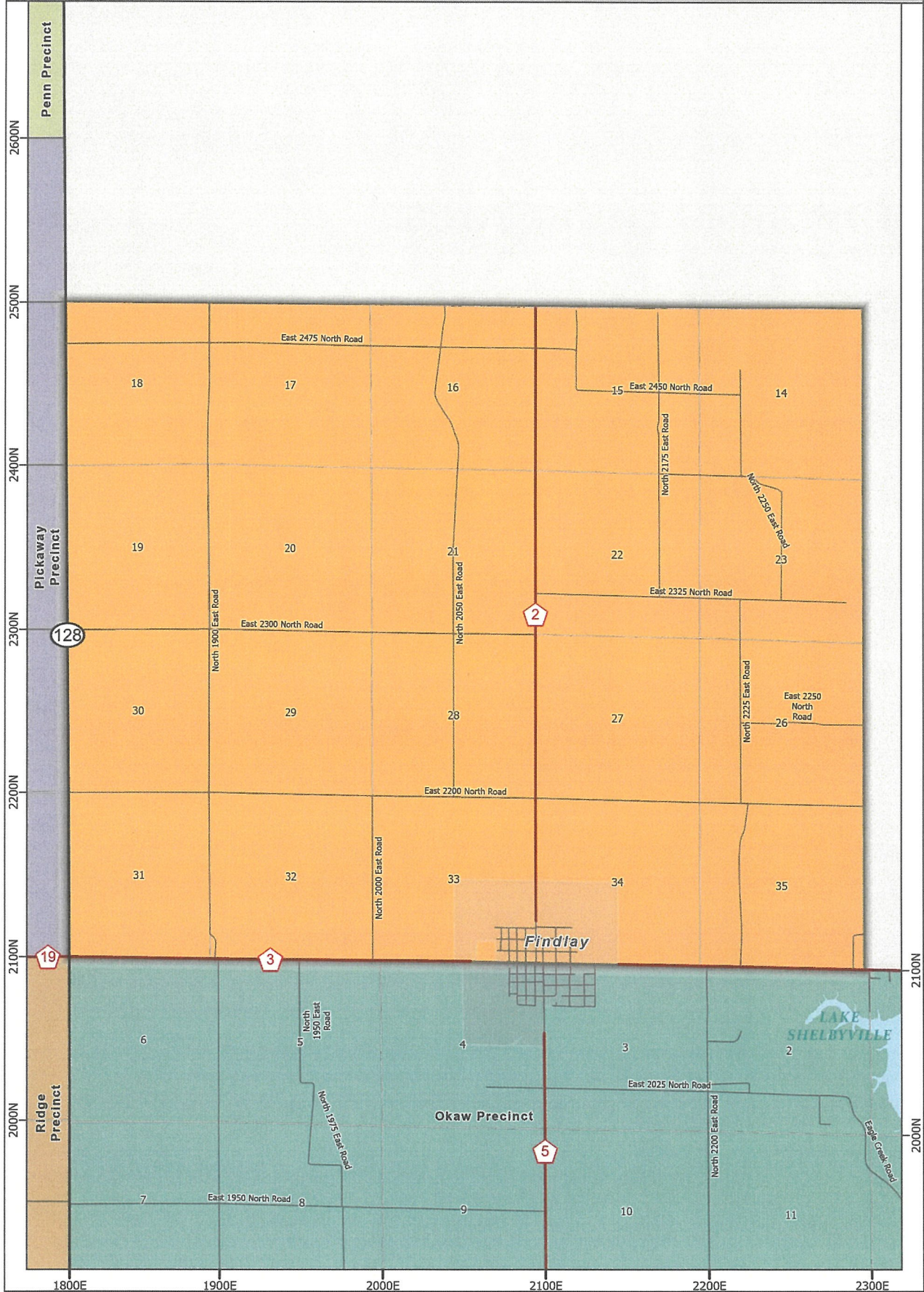
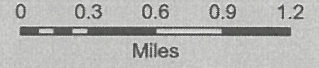

Shelby County Clerk/Recorder
301 E. Main St. PO Box 230
Shelbyville, IL 62565

Map Produced by:
Bruce Harris & Associates, Inc.
21 N. River St.
Batavia, IL 60510
www.bruceharris.com

August 2022

TOWER HILL PRECINCT

Shelby County Clerk

| | |
|----------------------|---------------------|
| Precincts | Hydrography |
| Sections | Political Townships |
| Corporate Boundaries | |

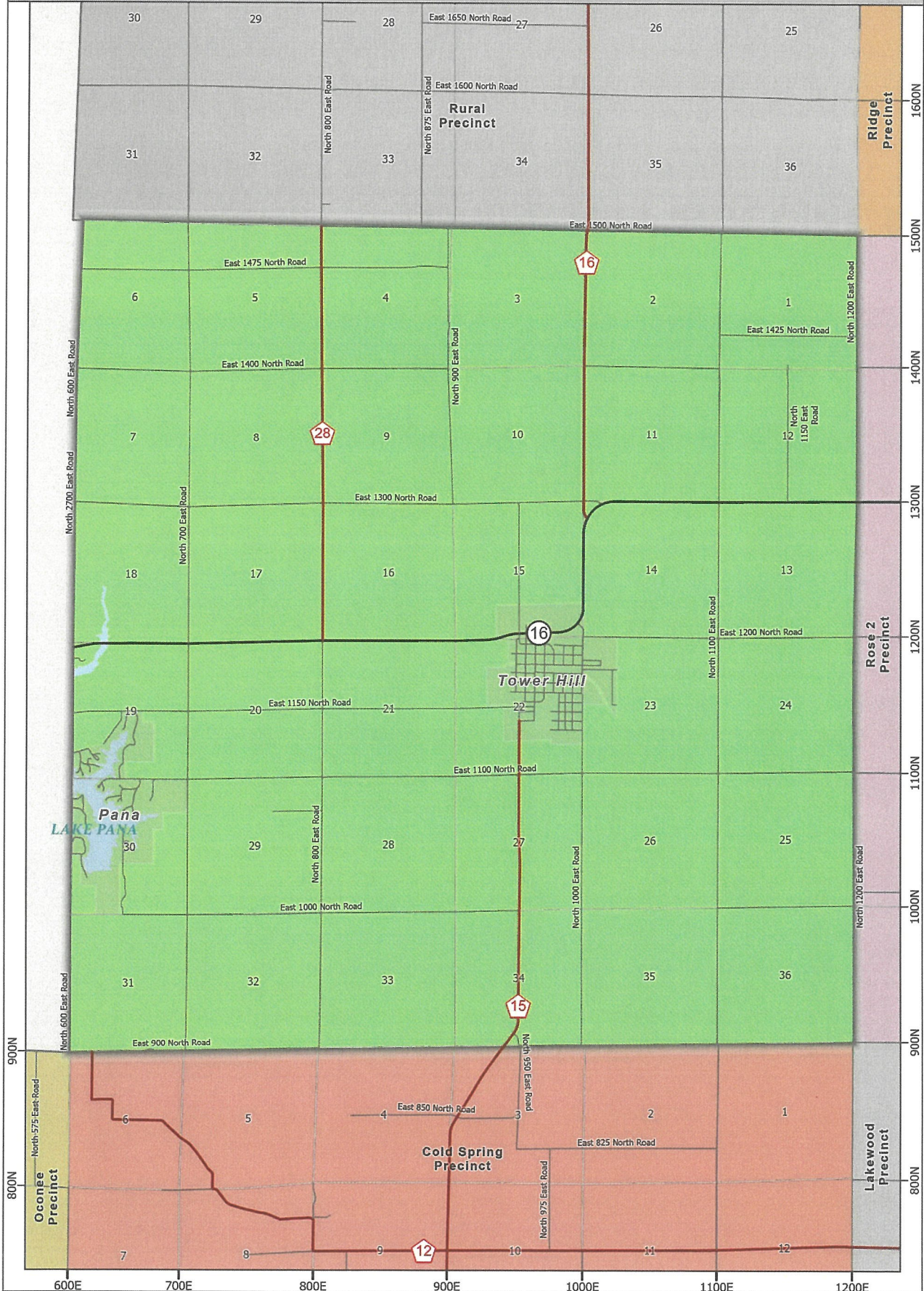
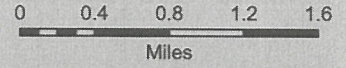

Shelby County Clerk/Recorder
301 E. Main St. PO Box 230
Shelbyville, IL 62565

Map Produced by:
Bruce Harris & Associates, Inc.
21 N. River St.
Bataavia, IL 60510
www.bruceharris.com

August 2022

WINDSOR 2 PRECINCT

Shelby County Clerk

| | |
|----------------------|---------------------|
| Precincts | Hydrography |
| Sections | Political Townships |
| Corporate Boundaries | |

